

Install a new lower bearing outer race and the ball race remover as shown. While holding the driver shaft, turn nut A gradually until the groove in driver attachment B aligns with the lower end of the steering head. This will allow you to install the upper bearing outer race.

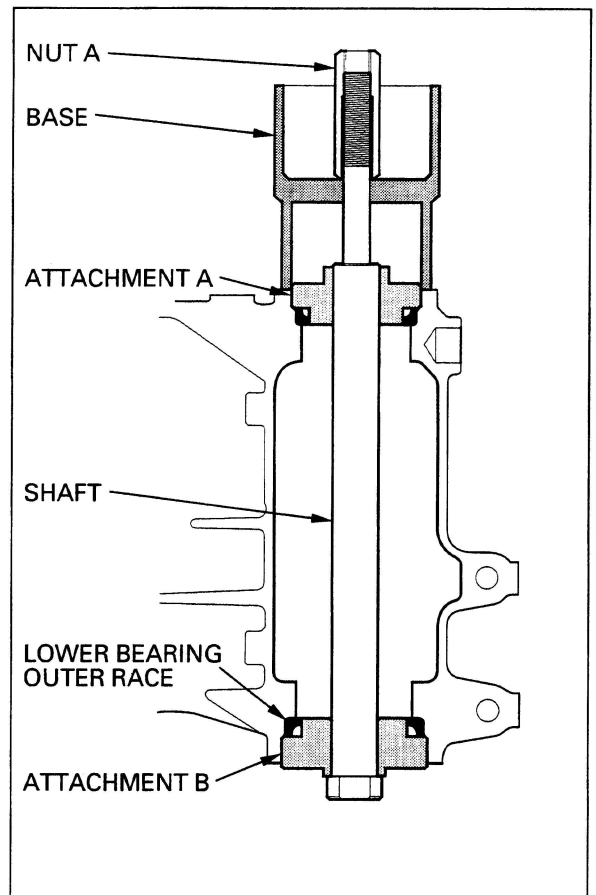

Install the stem nut onto the stem to prevent the threads from being damage when removing the lower bearing inner race from the stem. Remove the lower bearing inner race with a chisel or equivalent tool, being careful not to damage the stem. Remove the dust seal.

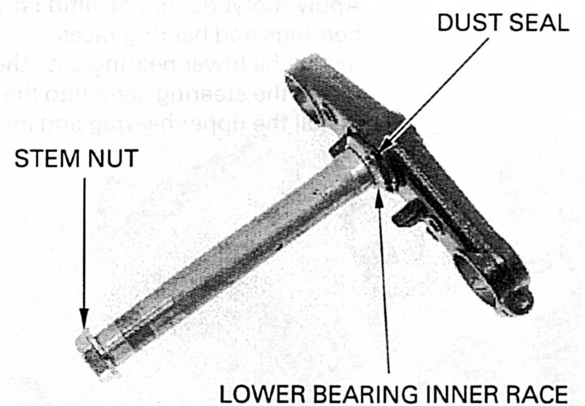

Apply molybdenum disulfide grease to a new dust seal lip and install it to the steering stem. Press a new lower bearing inner race onto the steering stem using the special tool.

TOOL:
Steering stem driver 07946-MB00000

