

ASSEMBLY

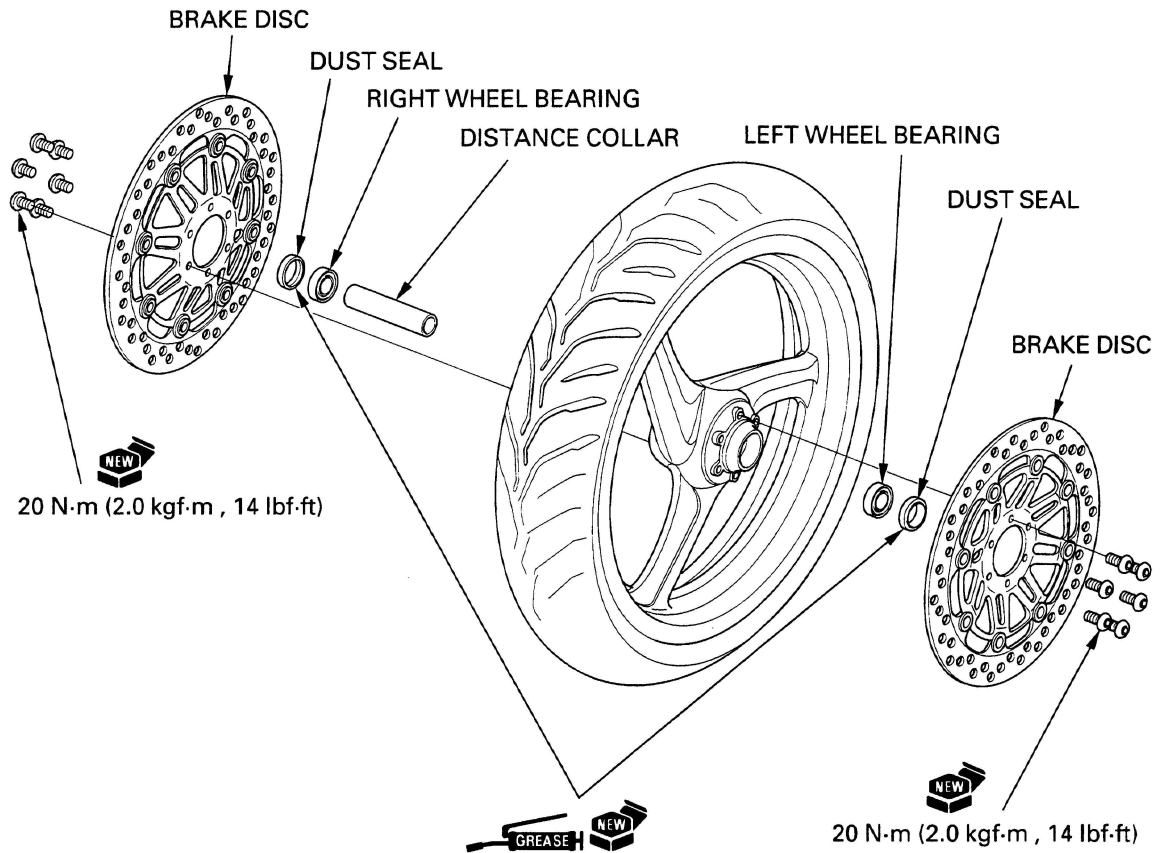

Drive in a new left bearing squarely with the marking side facing up until it is fully seated. Install the distance collar. Drive in a new right bearing squarely with the marking side facing up until it is fully seated.

TOOLS:

- | | |
|-------------------------------|---------------|
| Driver | 07749-0010000 |
| Attachment, 42 × 47 mm | 07746-0010300 |
| Pilot, 20 mm | 07746-0040500 |

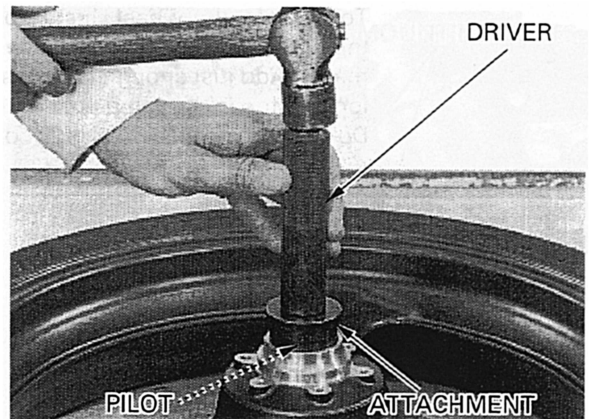

Install the brake discs with the arrow mark facing in the normal rotating direction. Install new disc bolts and tighten them in a criss-cross pattern in 2 or 3 steps.

TORQUE: 20 N·m (2.0 kgf·m, 14 lbf·ft)

