

Starter Motor Disassembly/Assembly

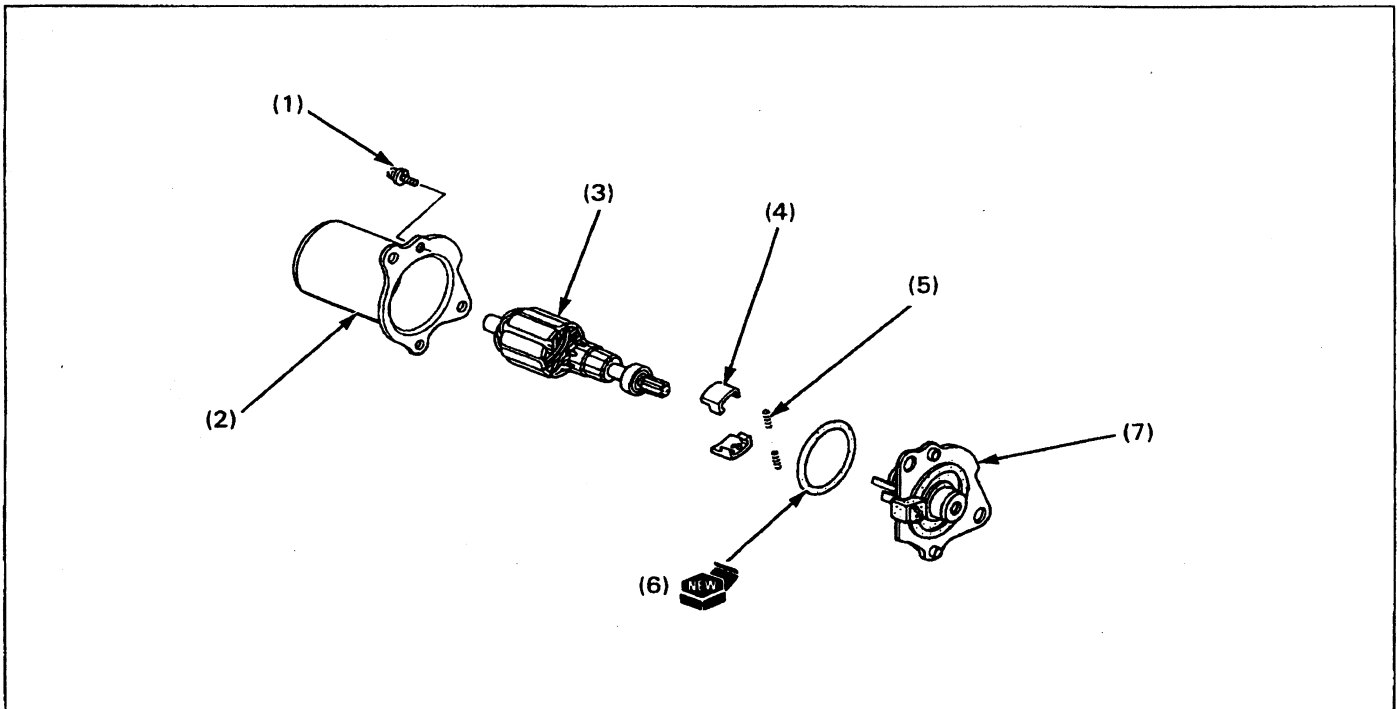

Requisite Service

- Starter motor removal/installation (page 15-4)

Procedure	Q'ty	Remarks
Disassembly Order		Assembly is in the reverse order of disassembly.
(1) Motor case screw	2	NOTE • When installing, make sure that there are no metal particle inside the case.
(2) Motor case	1	
(3) Armature	1	
(4) Brush holder	2	
(5) Spring	2	
(6) O-ring	1	
(7) Front bracket	1	