

- (1) BOOT
- (2) SNAP RING
- (3) PISTON ASSEMBLY
- (4) SPRING
- (5) OIL SEAL
- (6) CIRCLIP

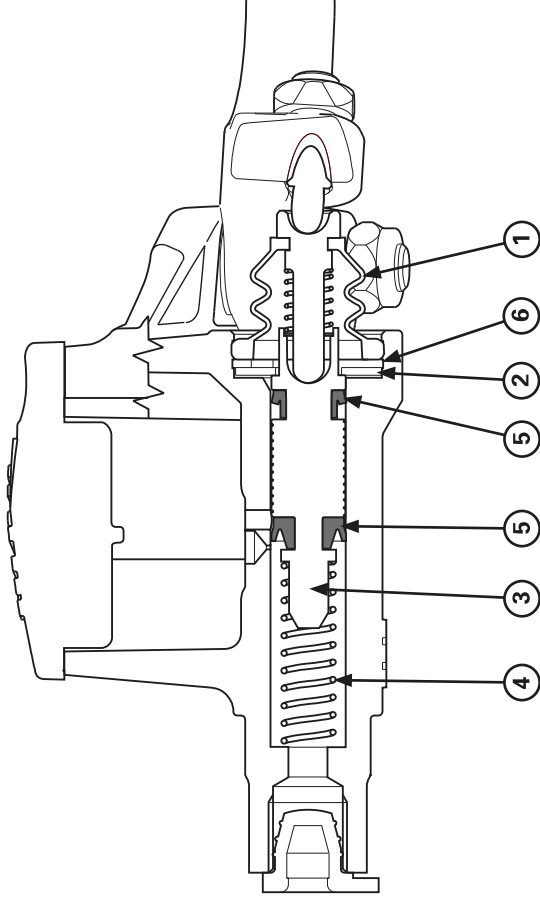

**Disassembly/Assembly**

**NOTICE**

- Keep the master cylinder piston, cups, spring and snap ring as a set; don't substitute individual parts.
- When installing the cups, do not allow the lips to turn inside out and be certain the snap ring is firmly seating in the groove.

Remove the snap ring and disassemble the master cylinder.

**Inspection**

Check the following items:

- Master cylinder and piston for scoring, scratches or other damage
- Master piston O.D. and master cylinder I.D.

**Installation**

Installation is in the reverse order of removal.

**Torque:**

**Brake hose oil bolt: 14 N•m (1.4 kgf•m, 10.3 lbf•ft)**  
**Master cylinder holder bolt: 5.5 N•m (0.5 kgf•m, 4.1 lbf•ft)**

Bleed the air in the front brake system.