

HYDRAULIC BRAKE

ASSEMBLY

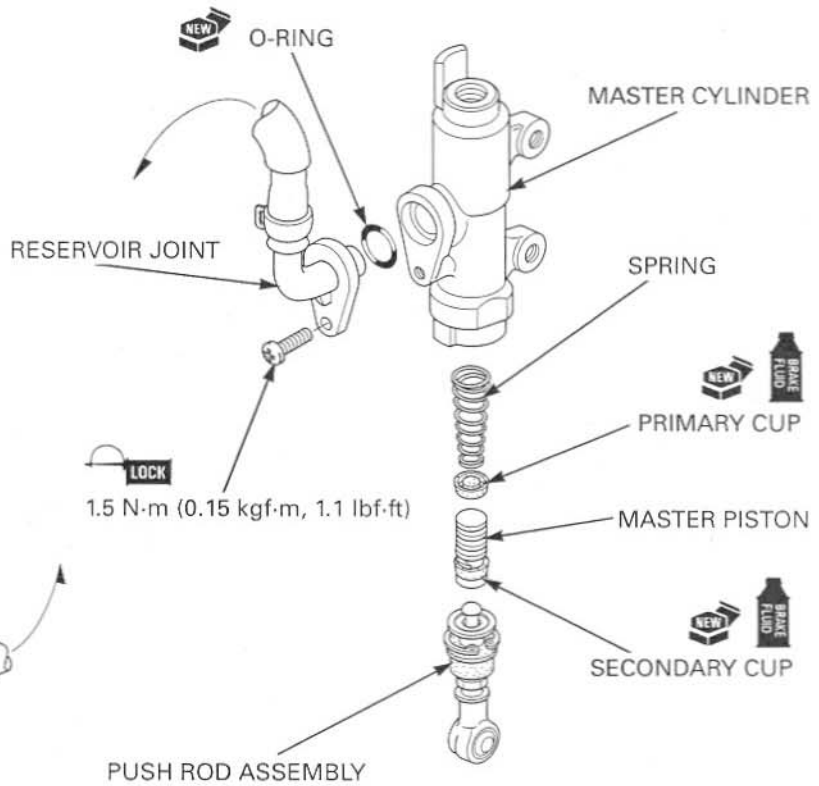
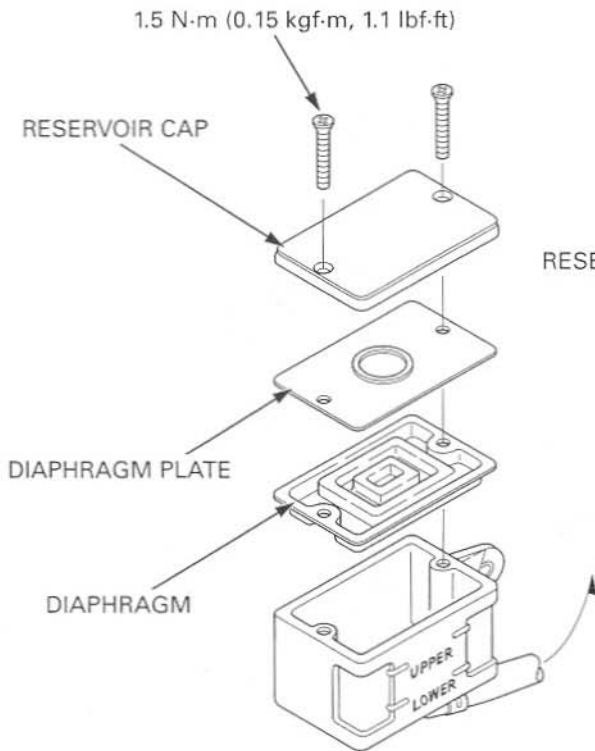

Keep the piston, cups, spring, snap ring and boot as a set; do not substitute individual parts.

When installing the cups, do not allow the lips to turn inside out.

If the push rod is disassembled, refer to (page 4-27) for push rod length adjustment.

Be certain the snap ring is firmly seated in the groove.

Coat all parts with clean brake fluid before assembly.

Dip the piston in brake fluid. Install the spring to the primary cup. Install the spring/primary cup and master piston assembly into the master cylinder. Apply silicone grease to the piston contact area of the push rod.

Install the push rod into the master cylinder.

Install the snap ring with the special tool.

TOOL:
Snap ring pliers

Install the boot.

07914-SA50001

