

Remove the pressure relief valve and O-ring.

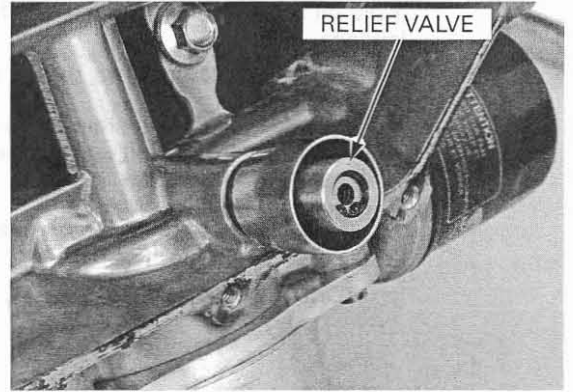

INSPECTION

Check the operation of the pressure relief valve by pushing on the piston.
Disassemble the relief valve by removing the snap ring.

Inspect the piston for wear, unsmooth movement or damage.
Inspect the spring for fatigue or damage.

Assemble the relief valve in the reverse order of disassembly.

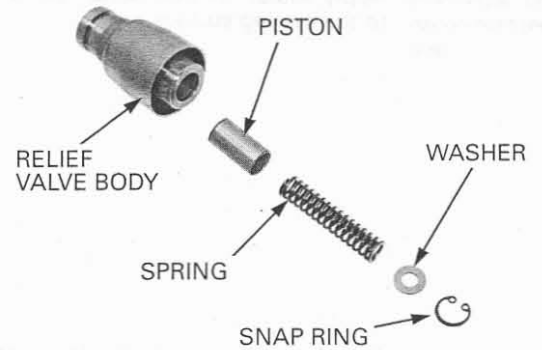

INSTALLATION

Apply oil to a new packing and install it onto the oil strainer flange.

Install the oil strainer into the oil pump while aligning the oil strainer boss with the groove of the oil pump.

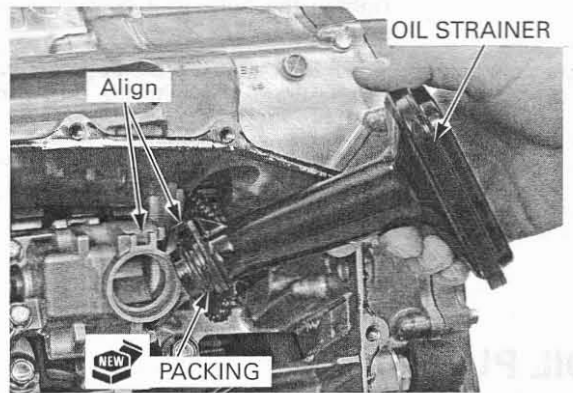

Apply oil to a new O-ring and install it onto the relief valve.

Install the relief valve into the crankcase.

