

Install the seat rail brace and then install the socket bolts.

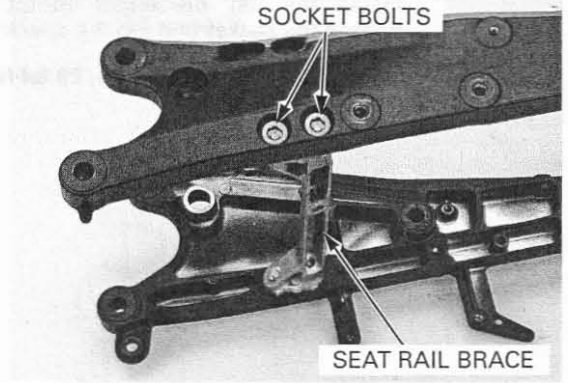

**INSTALLATION**

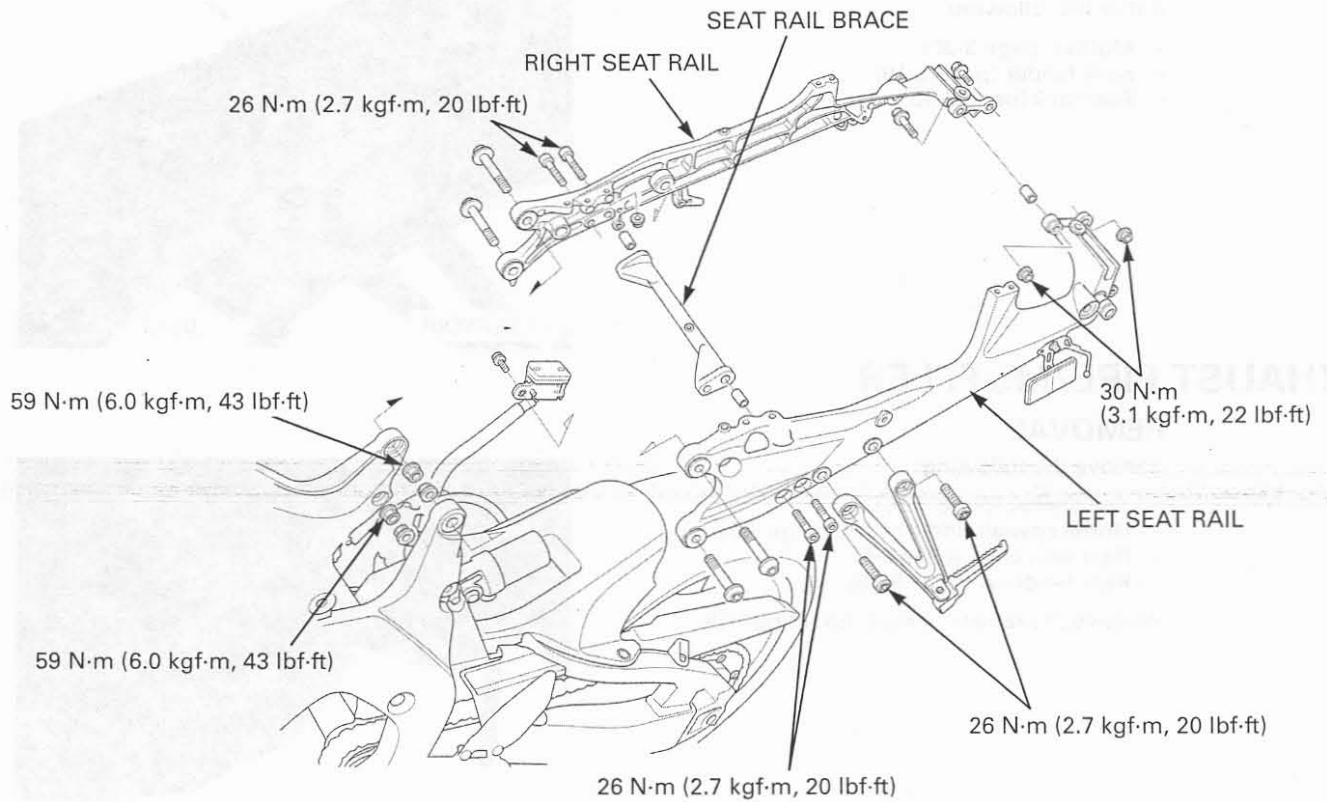

Install the seat rail to the frame.  
Install the upper mounting bolts/nuts and lower mounting bolts/collars/nuts.  
Tighten the bolts and nuts to the specified torque.

**TORQUE:**

- Upper mounting flange nut:  
59 N·m (6.0 kgf·m, 43 lbf·ft)
- Lower mounting flange nut:  
59 N·m (6.0 kgf·m, 43 lbf·ft)

Tighten the four seat rail brace socket bolts and seat rail assembly flange nuts to the specified torque.

**TORQUE:**

- Seat rail brace socket bolt:  
26 N·m (2.7 kgf·m, 20 lbf·ft)
- Seat rail assembly flange nut:  
30 N·m (3.1 kgf·m, 22 lbf·ft)

