

CYLINDER HEAD ASSEMBLY

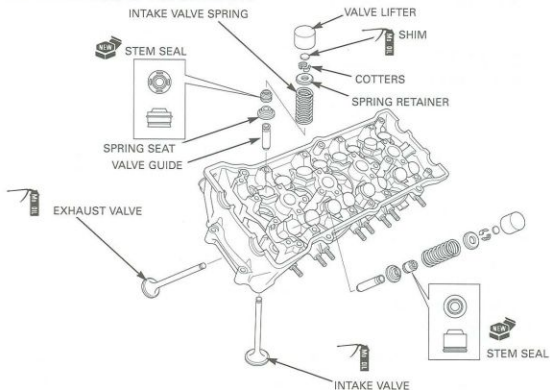

Blow through all oil passages in the cylinder head with compressed air.

Install the tappet hole protector into the valve lifter bore.

TOOL:

Tappet hole protector

07HMG-MR70002



*Grease the
cotters to ease
installation.*

Install the valve spring seats.
Install the new stem seals.

Lubricate the valve stems with molybdenum oil solution.
Insert the valve into the valve guide while turning it slowly to avoid damage to the stem seal.

