

REPLACEMENT

This motorcycle uses a drive chain with a staked master link.

Loosen the drive chain (page 3-16).
Assemble the special tool as shown.

TOOL:

Drive chain tool set

07HMH-MR10103

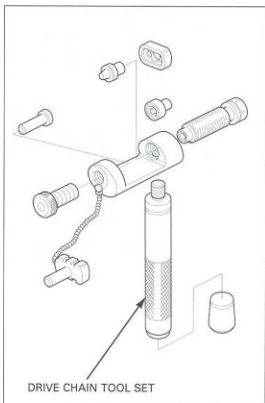

When using the special tool, follow the manufacturer's instruction.

Locate the crimped pin ends of the master link from the outside of the chain, and remove the link with the drive chain tool set.

TOOL:

Drive chain tool set

07HMH-MR10103

Remove the drive chain.

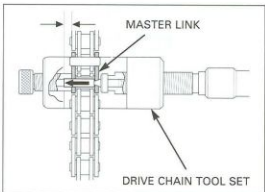

Include the master link when you count the drive chain links.

Remove the excess drive chain links from the new drive chain with the drive chain tool set.

STANDARD LINKS: 114 links

REPLACEMENT CHAIN:

DID: DID50VA8-114LE

RK: RK50HFOZ5-114LE

