

d. Reassembly

Perform the reassembly in the reverse order of disassembly by connecting each lead correctly in place. (Fig. 16-30)

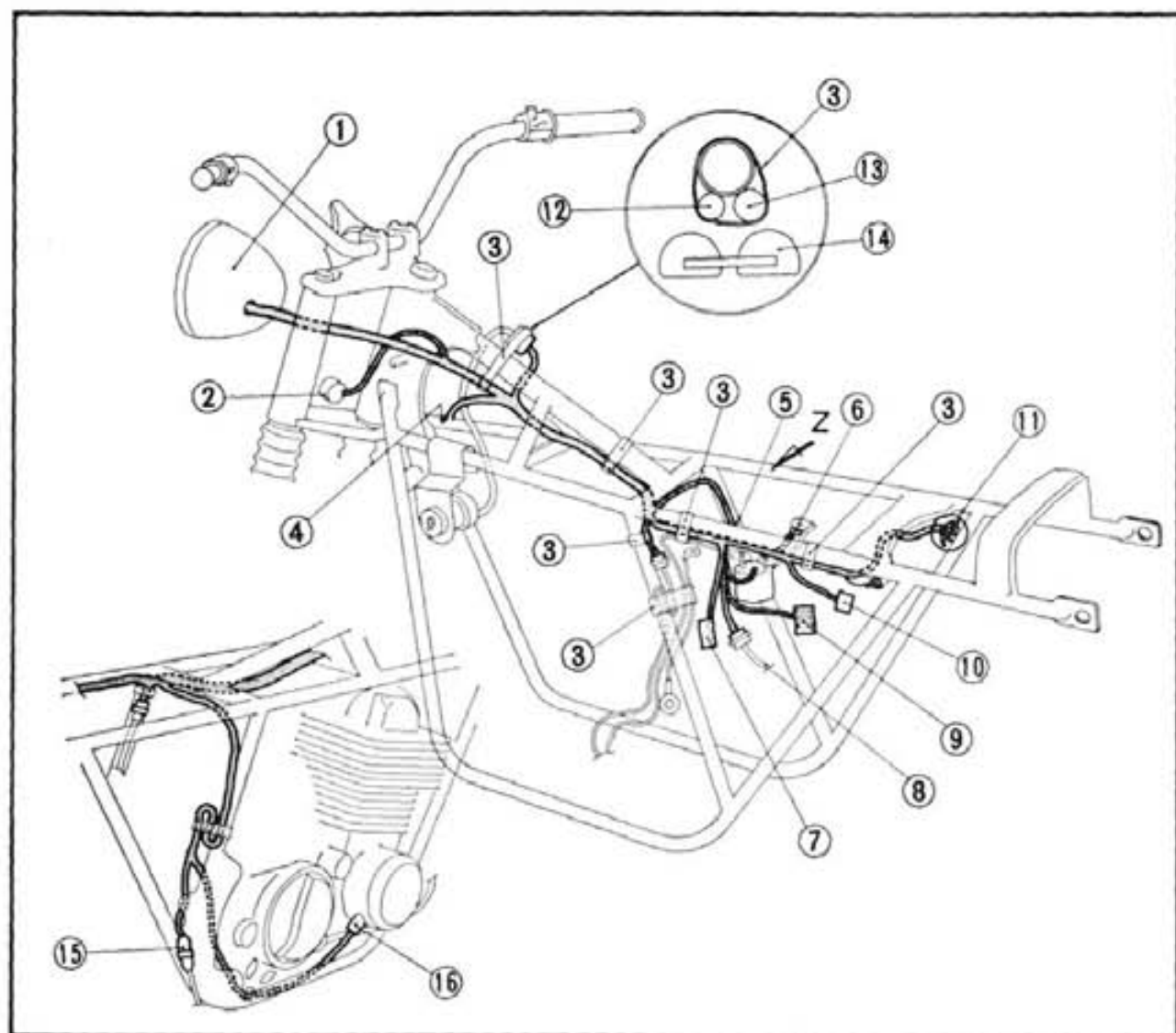

Fig. 16-30

- | | |
|--------------------------------------|--|
| ① Headlight | ⑨ To fuse |
| ② Stop switch (front) | ⑩ To flasher relay |
| ③ Wire harness band | ⑪ To tail/stop light and turn signal light |
| ④ To horn and ignition coil | ⑫ Wire harness |
| ⑤ To stop switch and contact breaker | ⑬ Main key switch coupler |
| ⑥ To battery | ⑭ Ignition coil |
| ⑦ To regulator | ⑮ Stop switch (rear) |
| ⑧ To rectifier | ⑯ To contact breaker points |