

- |                |                  |              |                |
|----------------|------------------|--------------|----------------|
| ① window glass | ④ Division plate | ⑦ Lower case | ⑩ Socket       |
| ② window plate | ⑤ Trip counter   | ⑧ Gear box   | ⑪ Socket cover |
| ③ Case         | ⑥ Total counter  | ⑨ Lamp bulb  |                |

Fig. 16-1



Fig. 16-2 ① Tachometer ② Speedometer ③ Setting screw

### b. Disassembly

1. Remove the headlight unit in accordance with 16-3. b on page 161, and disconnect the electrical leads which are from the speedo/tachometer.
2. Disconnect the speedometer and tachometer cables from back of the respective meter.
3. Loosen the meter setting screw and remove the meter from the meter bracket. (Fig. 16-2)
4. Remove the meter under plate by unscrewing the two cross screws and remove the meter bulbs.

### c. Inspection

1. Inspect the respective meter for defect or crack.

### d. Reassembly

Perform the reassembly in the reverse order of disassembly.

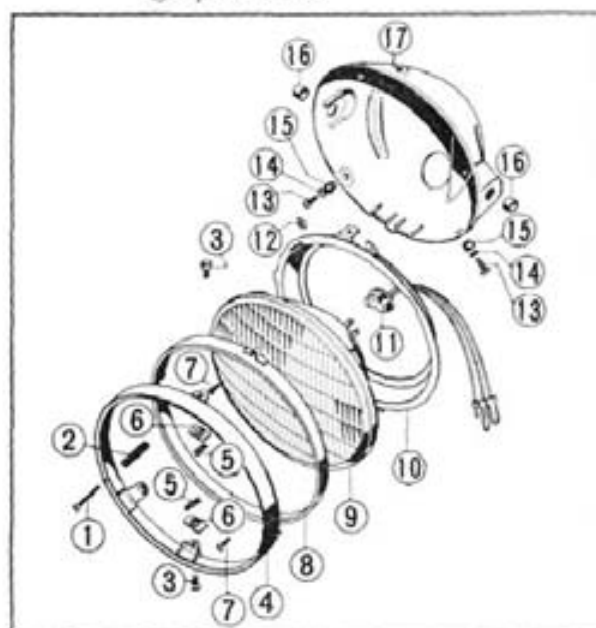

- |                         |                            |
|-------------------------|----------------------------|
| ① Beam adjusting screw  | ⑩ Mounting ring            |
| ② Beam adjusting spring | ⑪ Headlight cord socket    |
| ③ Unit holder screw     | ⑫ Beam adjusting nut       |
| ④ Headlight rim         | ⑬ 5 mm cross screw         |
| ⑤ 5 mm cotter pin       | ⑭ 5 mm spring washer       |
| ⑥ Unit holder nut       | ⑮ Headlight setting collar |
| ⑦ 3 mm cross screw      | ⑯ Headlight case collar    |
| ⑧ Retaining ring        | ⑰ Headlight case           |
| ⑨ Sealed beam unit      |                            |

Fig. 16-3

## 16-3 HEADLIGHT

### a. Description

The headlight is of sealed beam type and adjusted in the vertical and horizontal directions. (Fig. 16-3)