

d. Reassembly

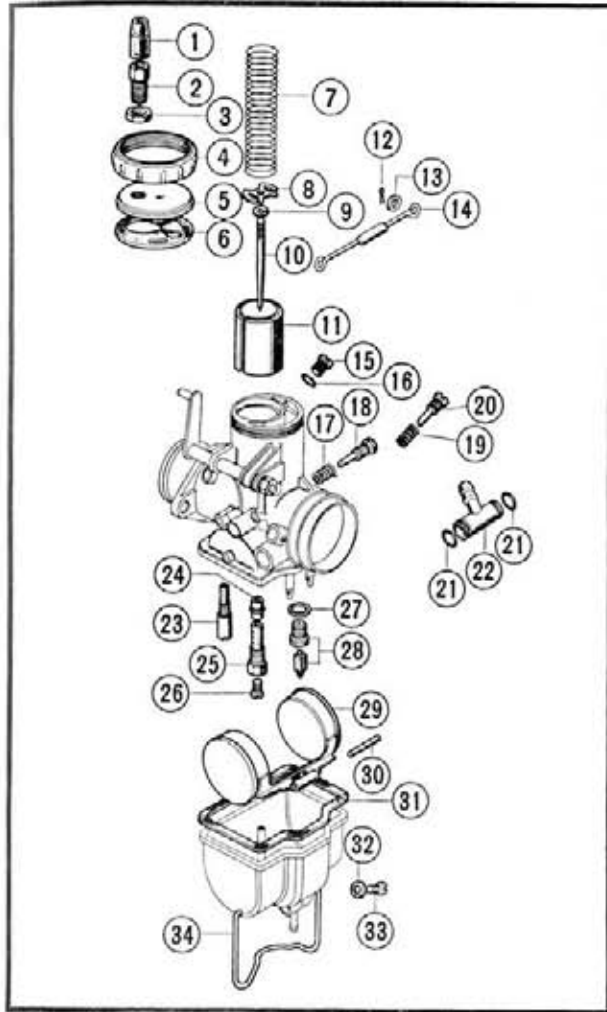

- | | |
|--------------------|------------------------------|
| ① Rubber cap | ⑱ Air screw |
| ② Cable adjuster | ⑲ Throttle stop screw spring |
| ③ Lock nut | ⑳ Throttle stop screw |
| ④ Cap | ㉑ 7.9×1.9 O-ring |
| ⑤ Top | ㉒ T-type fuel tube joint |
| ⑥ Top washer | ㉓ Slow jet |
| ⑦ Throttle spring | ㉔ Needle jet |
| ⑧ Needle set plate | ㉕ Needle jet holder |
| ⑨ Clip | ㉖ Main jet |
| ⑩ Jet needle | ㉗ Flat washer |
| ⑪ Throttle valve | ㉘ Float valve set |
| ⑫ 1.0×10 split pin | ㉙ Float |
| ⑬ 5 mm flat washer | ㉚ Float arm pin |
| ⑭ Choke rod | ㉛ Float chamber washer |
| ⑮ Plug screw | ㉜ 6 mm flat washer |
| ⑯ Flat washer | ㉝ Drain plug |
| ⑰ Air screw spring | ㉞ Float chamber set clip |

Fig. 6-9

1. Wash all the parts and dry completely with compressed air before reassembly.

Assemble the main jet and slow jet on respective location. (Fig. 6-10)

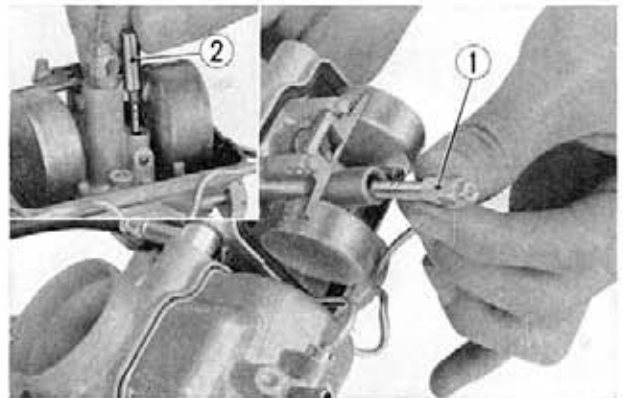

Fig. 6-10 ① Main jet ② Slow jet