

# CRANKSHAFT/TRANSMISSION

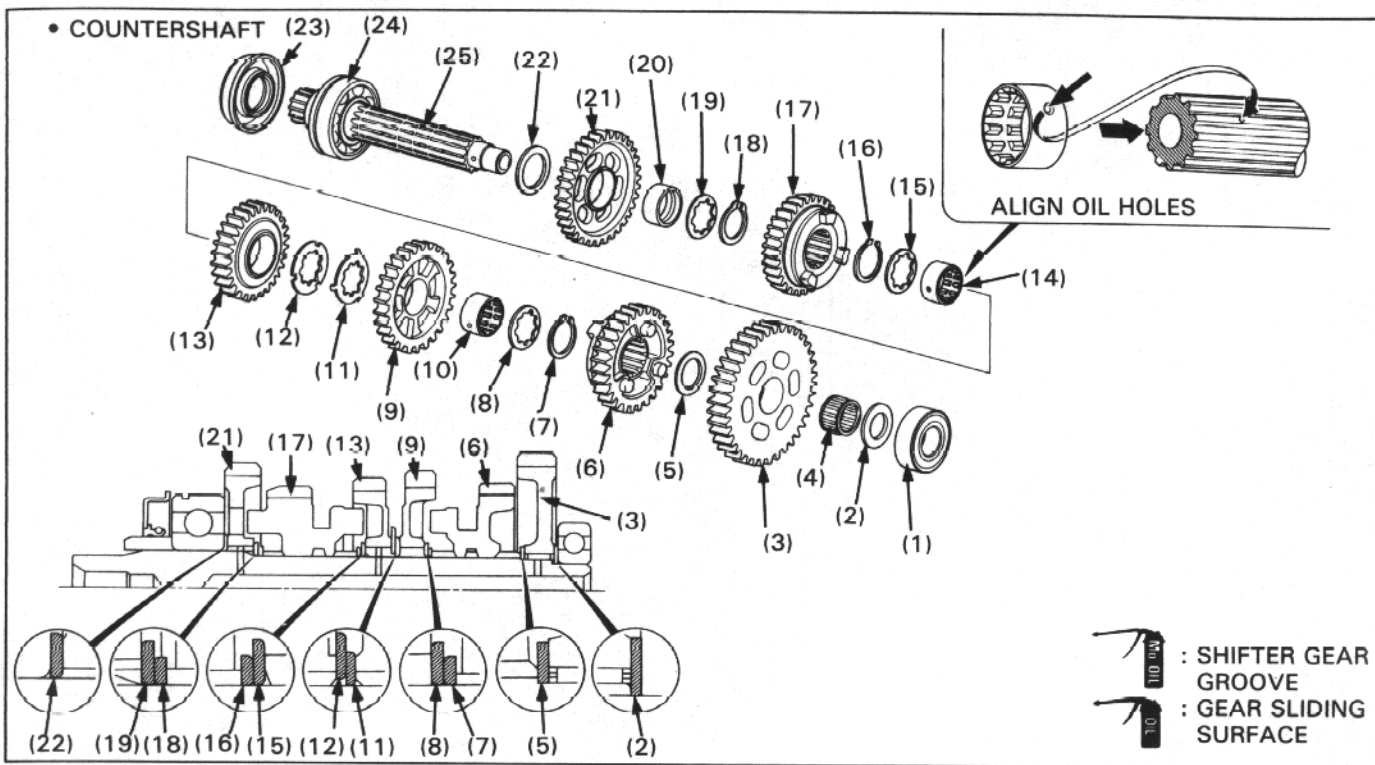

PROCEDURE	Q'ty	REMARKS
<b>COUNTERSHAFT DISASSEMBLY ORDER</b>		
(1) Bearing	1	• Assembly is in the reverse order of disassembly. Install with the sealed side facing outside.
(2) Thrust washer	1	
(3) C1 gear (43T)	1	Align the oil holes of the bushing and countershaft.
(4) Needle bearing	1	
(5) Thrust washer	1	
(6) C5 shifter gear (33T)	1	
(7) Snap ring	1	
(8) Spline washer	1	
(9) C3 gear (30T)	1	
(10) C3 spline bushing	1	
(11) Lock washer	1	
(12) Spline washer	1	
(13) C4 gear (35T)	1	Align the oil holes of the bushing and countershaft.
(14) C4 spline bushing	1	
(15) Spline washer	1	
(16) Snap ring	1	
(17) C6 shifter gear (32T)	1	
(18) Snap ring	1	
(19) Spline washer	1	
(20) C2 bushing	1	
(21) C2 gear (40T)	1	
(22) Thrust washer	1	
(23) Oil seal	1	
(24) Bearing	1	
(25) Countershaft	1	
		Install with the bearing stopper near the outside.