

# WATER PUMP DISASSEMBLY/ASSEMBLY

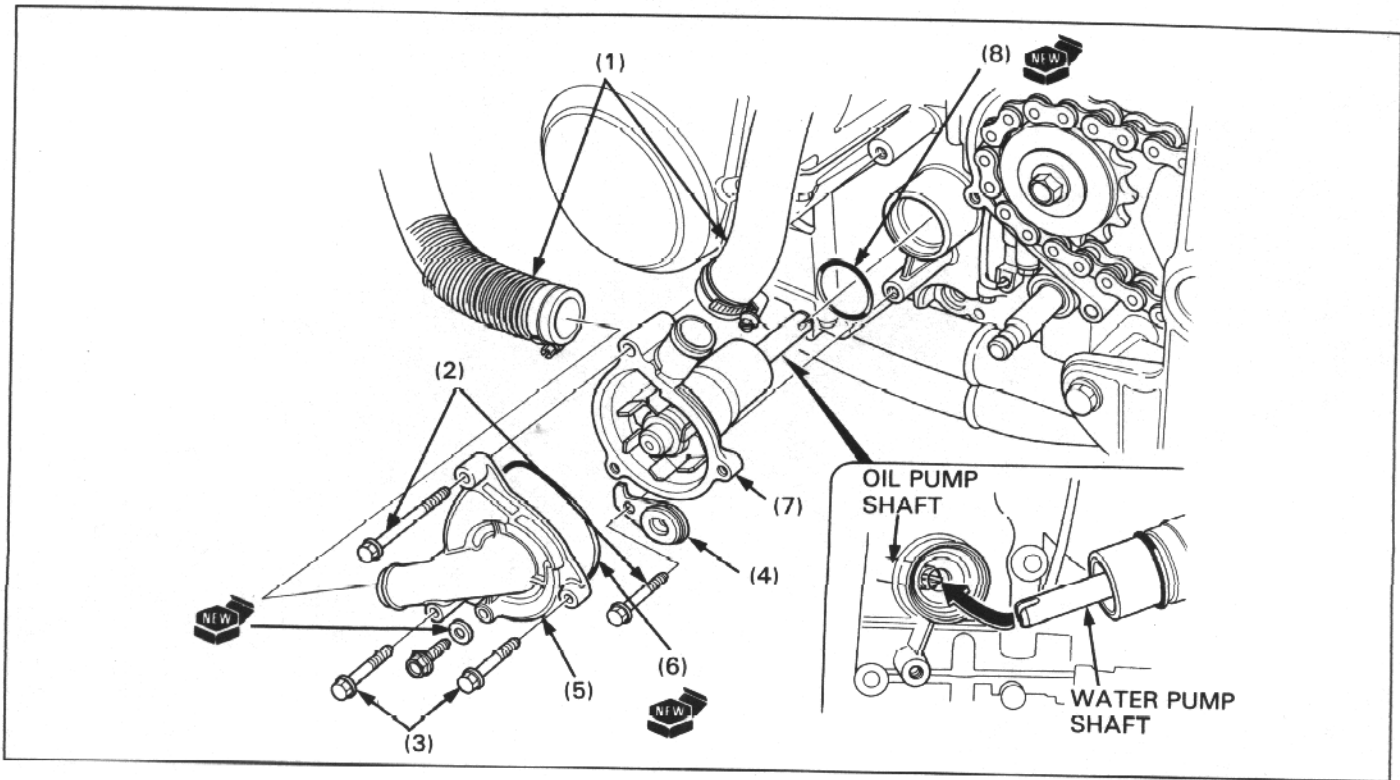

**NOTE**

- If the mechanical seal is damaged, the water pump must be replaced as an assembly.

**REQUISITE SERVICE**

- Coolant draining (page 5-3)
- Engine oil draining (drain bolt location: page 3-3, step: section 2 of the Common Service Manual)
- Coolant refill (section 5 of the Common Service Manual)
- Gearshift spindle joint removal/installation (page 9-6)
- Water pump side cover removal/installation (page 7-2)

PROCEDURE		Q'ty	REMARKS
<b>DISASSEMBLY ORDER</b>			
(1)	Radiator hose	2	• Assembly is in the reverse order of disassembly.
(2)	Water pump mounting bolt	2	
(3)	Water pump cover bolt	2	<b>NOTE:</b> • Before removing bolts, loosen the pump cover bolts(3).
(4)	Water pump side cover stay	1	
(5)	Water pump cover	1	At installation, align the pump shaft slot with the oil pump shaft.
(6)	O-ring	1	
(7)	Water pump body	1	
(8)	O-ring	1	