

1. GENERATOR

The generator is fundamentally an A.C. generator, with the rotor built in the engine flywheel. The design is essentially the same as that used on SL250S. Current available at the generator operates the ignition system to supply high-voltage surges to the spark plug in the engine cylinder.

2. A.C. GENERATOR

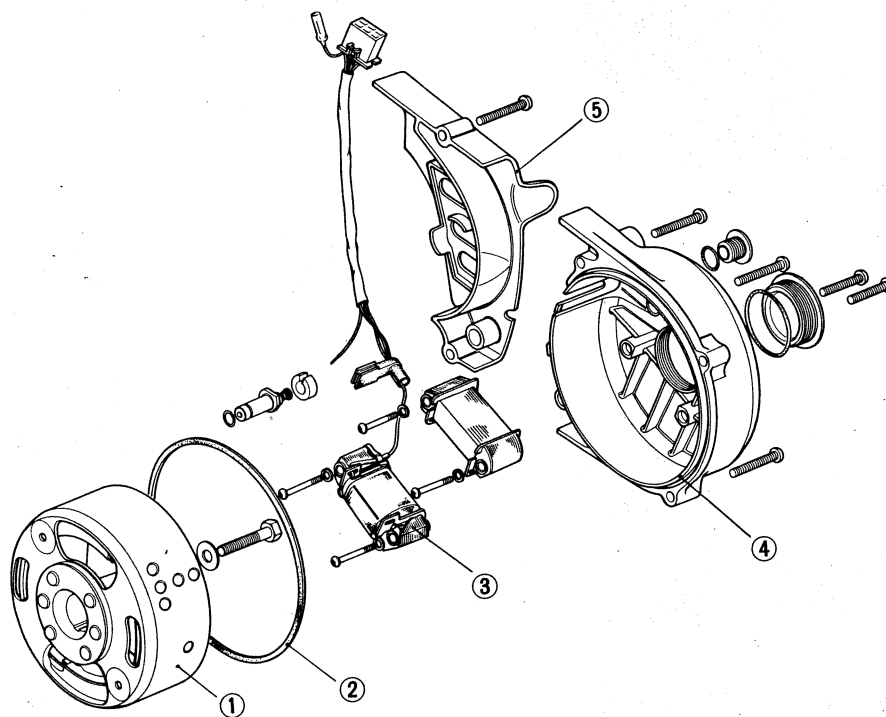

Fig. 45

- ① Flywheel
- ② Oil seal
- ③ Primary coil
- ④ Left crankcase cover
- ⑤ Left crankcase rear cover