

- 10) Reinstall the breaker point base assembly using the oil seal guide.
- 11) Reinstall the spark advance. (Fig. 47)
- 12) Reinstall the contact breaker assembly.
- 13) Install the point cover.

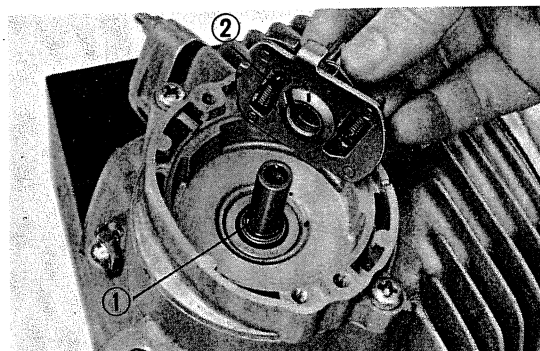

Fig. 47 Advance installation
① Pin ② Pin hole

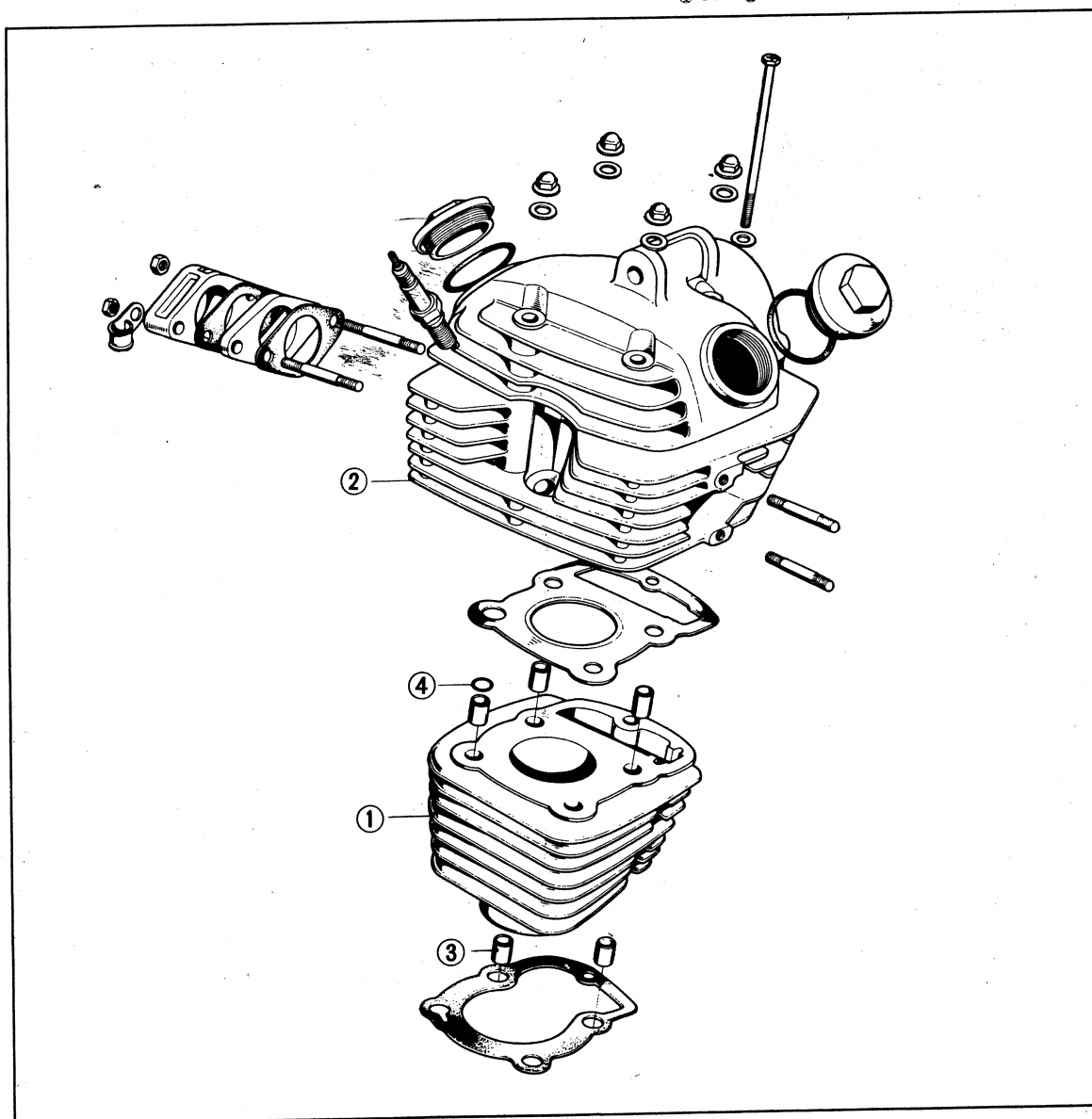

Fig. 48 ① Cylinder ② Cylinder head ③ Dowel pins ④ O ring