

- To adjust the head to top nut, first assemble the fork top bridge, front fork, headlight case, front fender and the front wheel in that order; tighten top nut so that the steering handle is neither too tight nor too loose when it is moved fully to the right and left.
- 3) Install the fork top bridge, front fork and wheel.
 - 4) Reconnect the throttle, clutch and front brake cables.
 - 5) Route the wire harnesses and control cables through their respective positions and then install the steering handle.

Note:

Check to make sure that the harnesses and cables are not binding when the steering handle is moved fully to both sides.

- 6) Reconnect all wire harnesses.
- 7) Adjust the play in all the cables. (Fig. 125, 126)

Throttle cable

(twist grip to full travel) 90°—100°
(play) 10°—15°

Front brake cable (at end of lever)
2-3 cm (3/4-1-1/8 in.)

Clutch cable (at end of lever)
1-2 cm (2/5-3/4 in.)

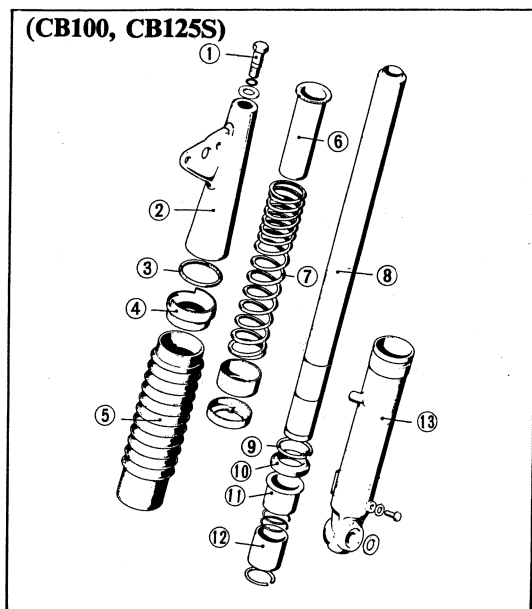
4. FRONT SUSPENSION**Fig. 127 CB100, CL100**

① Front fork bolt ② Front fork upper cover ③ Fork cover lower seat packing ④ Fork cover lower seat ⑤ Front fork under cover (CB100), Front fork boot (CL100) ⑥ Front fork spring guide ⑦ Front fork spring ⑧ Front fork piston ⑨ 37 mm circlip ⑩ Front fork oil seal ⑪ Front fork pipe guide ⑫ Front fork piston ⑬ Front fork bottom pipe

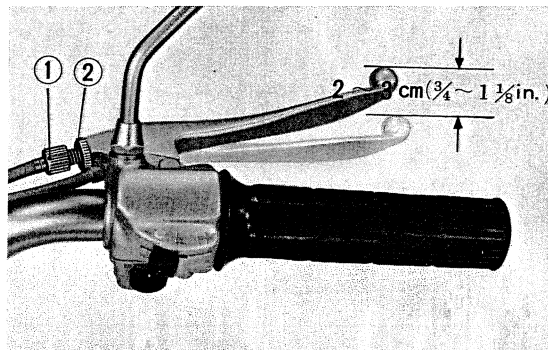
**Fig. 125 Brake cable play adjustment**

① Adjuster nut ② Lock nut

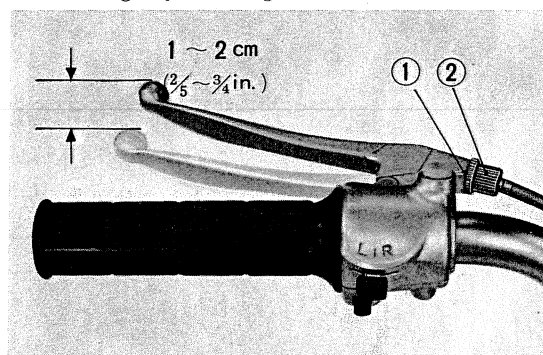
**Fig. 126 Clutch cable play adjustment**

① Lock nut ② Adjuster nut

