

L 1

F-27

Wire harness •
Ignition coil • Horn

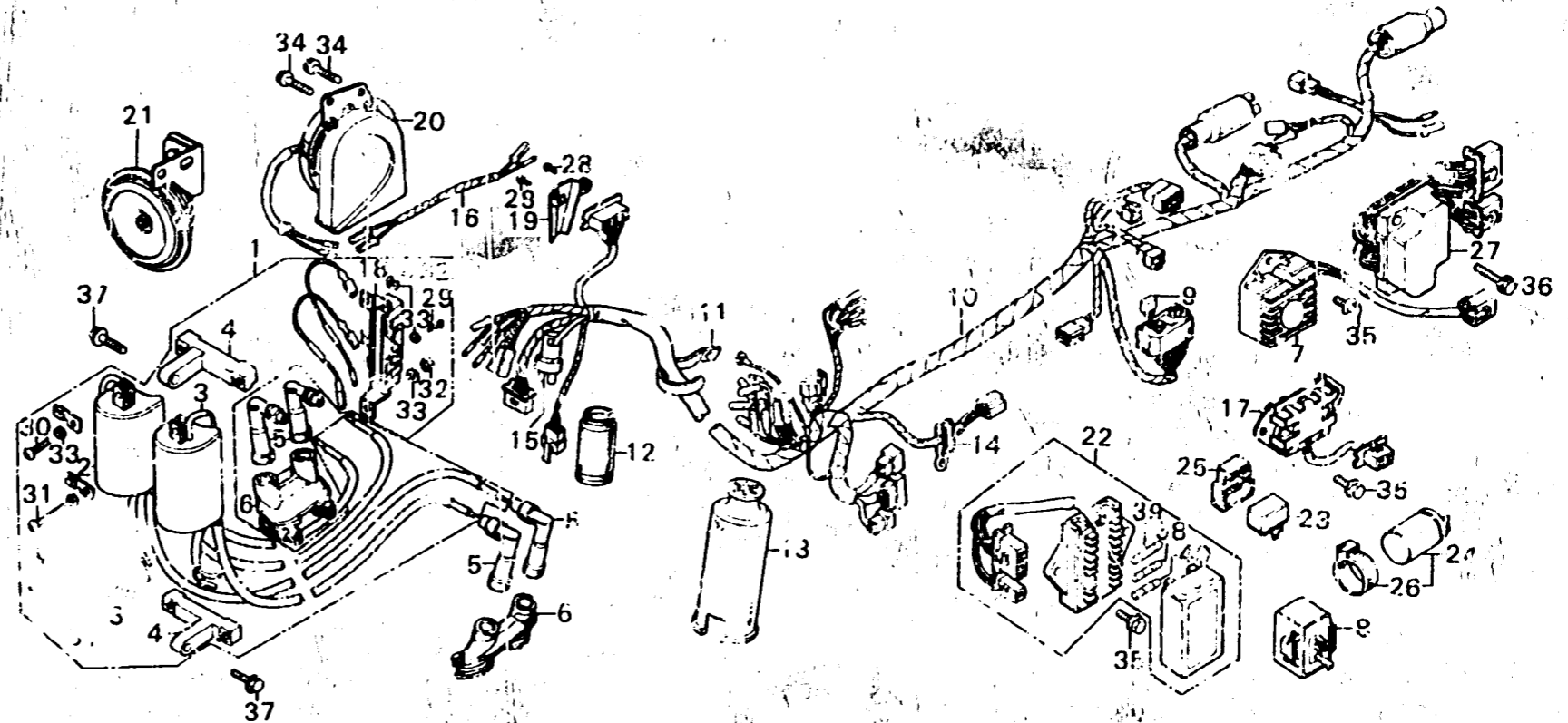

B371-42

Service item	F.R.T.	Ref. No.	Part No.	Description	Reqd. No.		Serial No.	Area code
					GL1000	GL1000 LTD K1 K2		
WIRE HARNESS	2.2	1	30500-371-003	COIL ASSY., IGNITION (TOYO)	1	1		
IGNITION COIL ASSY./RESISTOR	0.5		30530-371-003	COIL ASSY., IGNITION (TOYO)	1	1		
• Ignition coil one or all								
FUSE BOX ASSY.	0.2	2	30501-371-003	COIL, R. IGNITION (TOYO)	1	1		
HORN ASSY.	0.1	3	30502-371-003	COIL, L. IGNITION (TOYO)	1	1		
POINTLESS REGULATOR/7V REGULATOR/ SILICON RECTIFIER/HEAD LIGHT & TAIL LIGHT RESISTOR WINKER RELAY/ LIGHTING RESERVE UNIT	0.1	4	30511-300-000	BRACKET, IGNITION COIL	2	2		
• One motorcycle 0.2		5	30701-323-013	CAP ASSY. C, NOISE SUPPRESSOR	4			
			30701-323-023	CAP ASSY. C, NOISE SUPPRESSOR	4		2016546	A,DK,DM,U
			30701-371-000	CAP ASSY. C, NOISE SUPPRESSOR	4		2016547	2040165 A,DK,DM,U
			30700-371-153	CAP ASSY. C, NOISE SUPPRESSOR	4		2040166	2040165 CM,E,ED,F,G DK,DM,E,ED,F,G,U A,DK,DM,E,ED,F,G,U CM
		6	30700-371-000	SEAL, SUPPRESSOR	2	2		
		7	31400-371-003	REGULATOR, POINTLESS (KOKUSAN)	1	1		
		8	31410-371-007	REGULATOR ASSY. (7V)	1	1		
			31410-371-008	REGULATOR ASSY., 7V	1	1		
		9	31710-371-008	RECTIFIER, SILICON	4	4		
				(SHINDENGEN)				
				(SHINDENGEN)				
		10	32100-371-670	HARNESS, WIRE	2	2		
			32100-371-000	HARNESS, WIRE	1	1		DK,DM,E,ED,F,G,U A,CM DK,DM,E,ED,F,G,U
		11	32111-371-000	CLAMPER, HARNESS	1	1		
		12	32138-371-000	COVER, COUPLER SET	1	1		
		13	32150-121-000	COVER, CONNECTOR	1	1		
		14	32172-315-000	CLIP, WIRE HARNESS	1	1		
		15	32197-371-000	COVER, STOP SWITCH	1	1		

1979.04.10

L1