

D 14

E-11

Cylinder block - Breather chamber

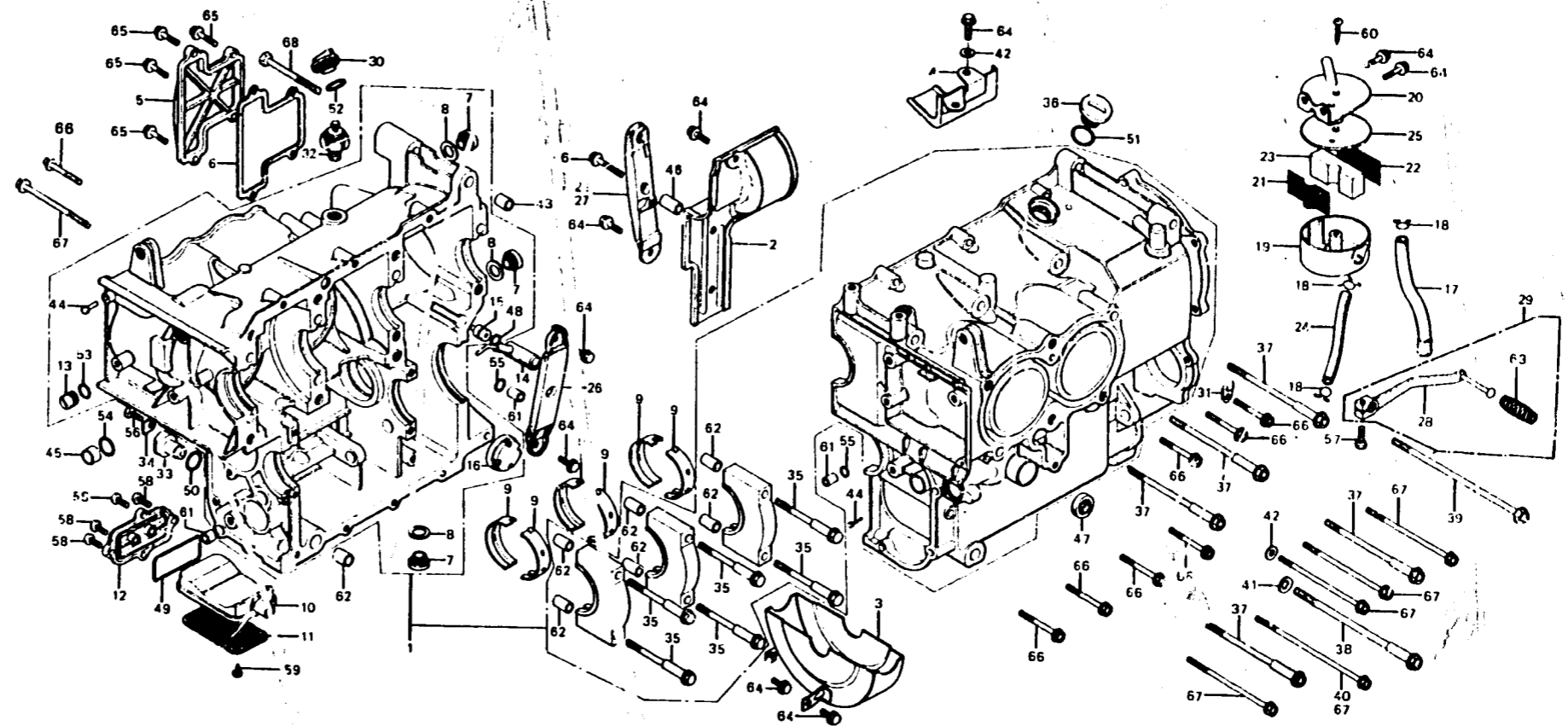

E371-11

Service item	F.R.T.	Ref. No.	Part No.	Description	Reqd. No.		Serial No.	Area code																									
					GL1000	GL1000 LTD K1 K2																											
			13322-371-003	BEARING B, MAIN (BLACK)	6	6	6	Selection table of main bearing (Oil clearance 20~44μm)																									
			13323-371-003	BEARING C, MAIN (BROWN)	6	6	6																										
			13324-371-003	BEARING D, MAIN (GREEN)	6	6	6																										
			13325-371-003	BEARING E, MAIN (YELLOW)	6	6	6																										
		10	15151-371-000	CASE, OIL STRAINER	1	1	1																										
		11	15152-371-000	SCREEN, OIL STRAINER	1	1	1	<table border="1"> <tr> <td></td> <td>Cylinder block I.D. 52φ</td> <td>(Mark) A or I</td> <td>B or II</td> <td>C or III</td> </tr> <tr> <td></td> <td></td> <td>0 ~+0.008</td> <td>+0.008~+0.016</td> <td>+0.016~+0.024</td> </tr> <tr> <td>(Mark)</td> <td>0 ~-0.008</td> <td>E (Yellow)</td> <td>D (Green)</td> <td>C (Brown)</td> </tr> <tr> <td></td> <td>-0.008~-0.016</td> <td>D (Green)</td> <td>C (Brown)</td> <td>B (Black)</td> </tr> <tr> <td></td> <td>-0.016~-0.024</td> <td>C (Brown)</td> <td>B (Black)</td> <td>A (Blue)</td> </tr> </table>		Cylinder block I.D. 52φ	(Mark) A or I	B or II	C or III			0 ~+0.008	+0.008~+0.016	+0.016~+0.024	(Mark)	0 ~-0.008	E (Yellow)	D (Green)	C (Brown)		-0.008~-0.016	D (Green)	C (Brown)	B (Black)		-0.016~-0.024	C (Brown)	B (Black)	A (Blue)
	Cylinder block I.D. 52φ	(Mark) A or I	B or II	C or III																													
		0 ~+0.008	+0.008~+0.016	+0.016~+0.024																													
(Mark)	0 ~-0.008	E (Yellow)	D (Green)	C (Brown)																													
	-0.008~-0.016	D (Green)	C (Brown)	B (Black)																													
	-0.016~-0.024	C (Brown)	B (Black)	A (Blue)																													
		12	15153-371-000	COVER, OIL STRAINER	1	1	1																										
			15153-371-980	COVER, OIL STRAINER		1																											
		13	15337-300-010	PLUG, OIL TUBE	1	1	1																										
		14	15520-371-000	NOZZLE, OIL SUPPLY	1	1	1																										
		15	15530-371-000	ORIFICE, CHAIN	1	1	1																										
		16	15661-371-005	FINDER, OIL LEVEL	1																												
			15661-371-015	FINDER, OIL LEVEL		1																											
					1	1																											
		17	15706-371-000	TUBE, OIL DRAIN	1	1	1																										
		18	15772-351-000	CLIP, TUBE	3	3	3																										
			15772-371-980	CLIP, BREATHER TUBE		3																											
		19	17271-371-000	CHAMBER, BREATHER	1	1	1																										
			17271-371-010	CHAMBER, BREATHER			1																										
		20	17274-371-003	BRACKET, BREATHER CHAMBER	1	1																											
			17274-371-013	BRACKET, BREATHER CHAMBER			1																										
			17274-371-980	BRACKET, BREATHER CHAMBER	1																												
		21	17275-371-000	NET A, WIRE	1	1	1																										
			17275-371-010	NET A, WIRE			1																										

1979.04.10

D14