

**C 11**

**E-4**

**Camshaft valve**

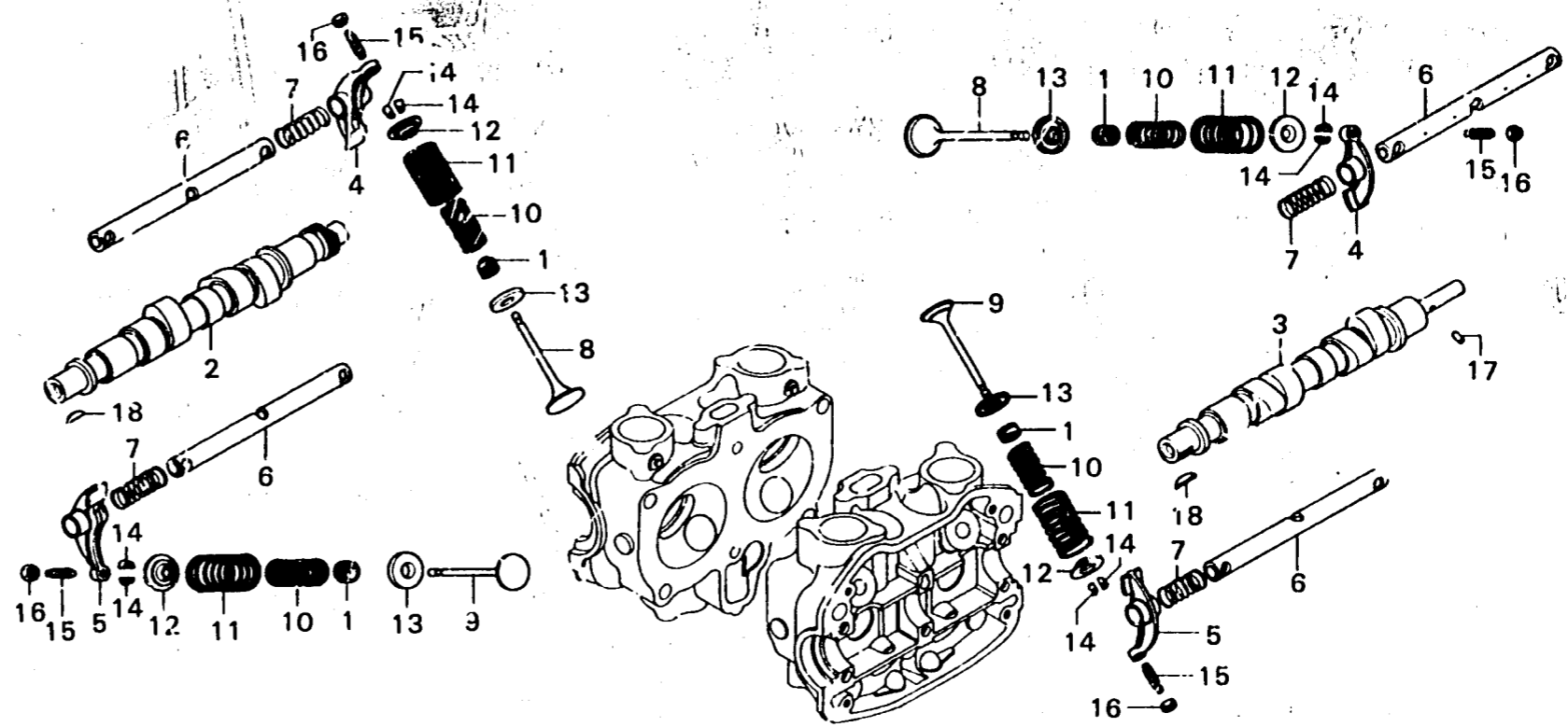

B371-4

Service item	F.R.T.	Ref. No.	Part No.	Description	Reqd. No.				Serial No.	Area code
					GL1000	GL1000	GL1000	GL1000		
VALVE	1.4	1	12209-300-003	SEAL, VALVE STEM	8	8	8	8		
•Add 0.2 reaming included		2	14110-371-000	CAMSHAFT COMP., R.						
VALVE SPRING and its related parts	1.3		14110-371-010	CAMSHAFT COMP., R.	1		1		2028170	
•Add 0 1							1		2028171	
L. CAMSHAFT/ROCKER ARM and its related parts	0.9	3	14211-371-300	CAMSHAFT, L.	1	1	1	1		
R. CAMSHAFT/ROCKER ARM and its related parts	0.7	4	14611-371-000	ARM A, ROCKER	4	4	4	4		
		5	14621-371-000	ARM B, ROCKER	4	4	4	4		
		6	14631-371-000	SHAFT, ROCKER ARM	4	4	4	4		
		7	14642-371-000	SPRING, ROCKER ARM SIDE	8	8	8	8		
		8	14711-371-000	VALVE, IN.	4	4	4	4		
		9	14721-371-000	VALVE, EX.	4	4	4	4		
		10	14731-611-003	SPRING, VALVE INNER (NIPPON HATSUJO)	8	8	8	8		
		11	14761-611-003	SPRING, VALVE OUTER (NIPPON HATSU)	8	8	8	8		
		12	14771-551-020	RETAINER, VALVE SPRING	8	8	8	8		
		13	14775-300-000	SEAT, VALVE SPRING	8	8	8	8		
		14	14781-551-000	COTTER, VALVE	16	16	16	16		
		15	90012-300-000	SCREW, TAPPET ADJUSTING	8	8	8	8		
		16	90205-300-000	NUT, TAPPET ADJUSTING	8	8	8	8		
		17	90701-283-000	PIN, KNOCK, 3X6,8	1	1	1	1		
		18	94401-25140	KEY, WOODRUFF, 25X34	2	2	2	2		

1979.04.10

C11