

F 10

F-16

## Exhaust muffler

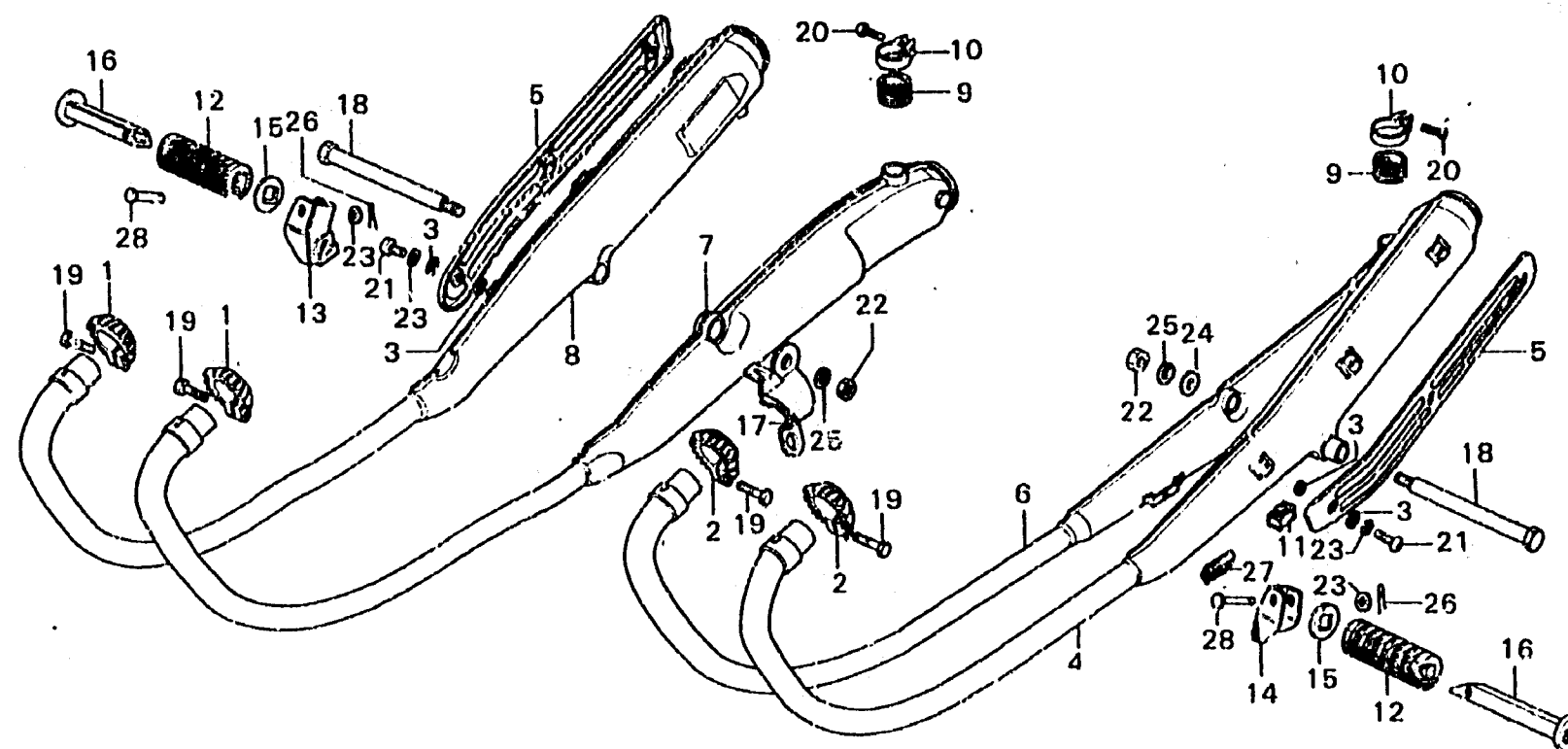

B341-20

Service item	F.R.T.	Ref. No.	Part No.	Description	Reqd. No. CB750K6	Serial No.	Area code
EXHAUST MUFFLER COMP.	0.2	1	18231-300-010	JOINT, R. EX. PIPE	2		
• Add 0.1		2	18232-300-010	JOINT, L. EX. PIPE	2		
• One motorcycle 0.5		3	18292-290-000	GASKET, PROTECTOR	12		
MUFFLER PROTECTOR	0.1	4	18300-341-900	MUFFLER COMP. 1; EX.	1		
• One or all		5	18315-300-020	PROTECTOR, MUFFLER	2		
PILION STEP BAR and its related parts	0.1	6	18350-341-900	MUFFLER COMP. 2; EX.	1		
		7	18400-341-900	MUFFLER COMP. 3; EX.	1		
		8	18450-341-900	MUFFLER COMP. 4; EX.	1		
		9	18472-300-000	TUBE, MUFFLER CONNECTING	2		
		10	18473-300-000	BAND, MUFFLER CONNECTING	2		
		11	50524-001-000	RUBBER, MAIN STAND STOPPER	1		
		12	50710-377-000	RUBBER, PILLION STEP	2		
		13	50711-341-670	BRACKET, R. PILLION STEP	1		
		14	50712-341-670	BRACKET, L. PILLION STEP	1		
		15	50712-377-000	WASHER, PILLION STEP	2		
		16	50715-377-000	BAR, PILLION STEP	2		
		17	55109-341-900	GUIDE, BREATHER	1		
		18	90146-300-020	BOLT, PILLION STEP	2		
		19	92000-08032-0A	BOLT, HEX., 8X32	4		
		20	93500-05016-0A	SCREW, PAN, 5X16	2		
		21	93500-06012-49	SCREW, PAN, 6X12	6		
		22	94030-12000	NUT, HEX., 12MM	2		
		23	94101-06000	WASHER, PLAIN, 6MM	8		
		24	94102-12000	WASHER, PLAIN, 12MM	1		
		25	94111-12000	WASHER, SPRING, 12MM	2		

1978.02.20

F-16