

E 2

F-1-2

Headlight (DK,DM,E,U)

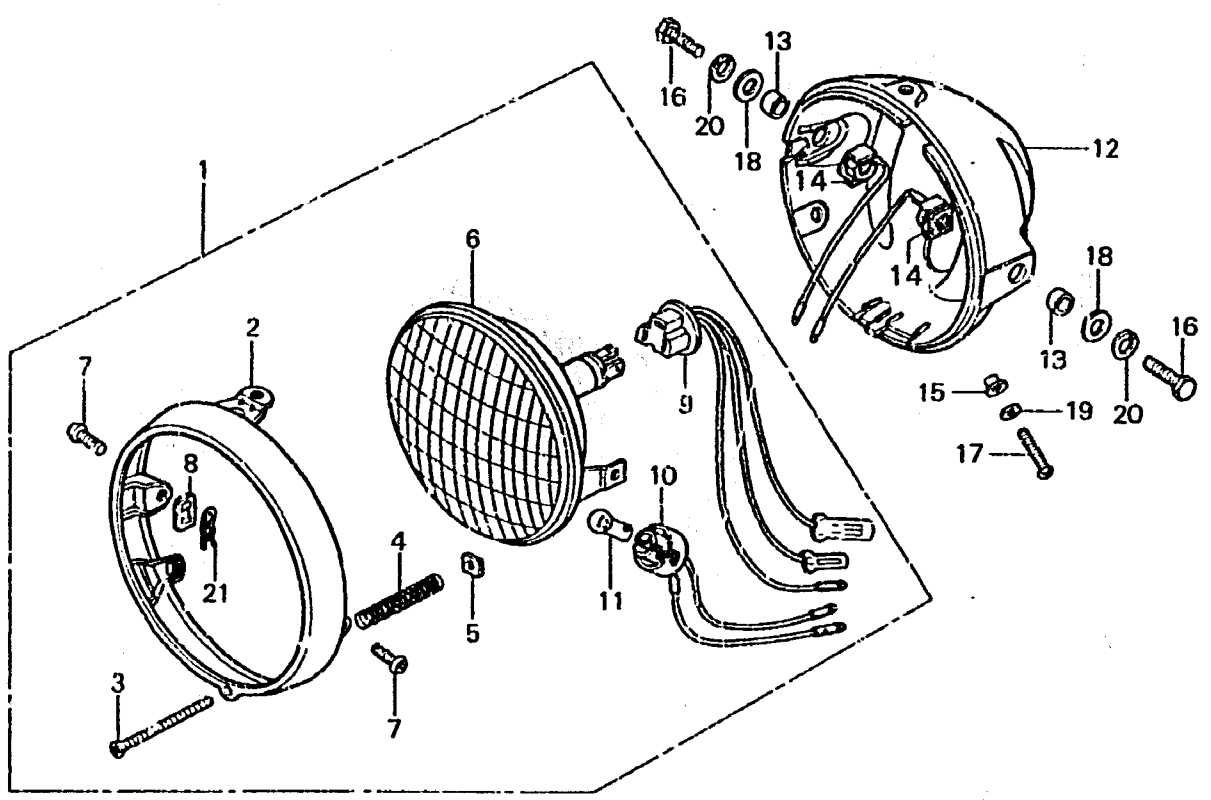

B341-3

| Service item | F.R.T. | Ref. No. | Part No. | Description | Reqd. No. CB750K6 | Serial No. | Area code |
|--------------------------------------|--------|----------|----------------|---------------------------------------|-------------------|------------|-----------|
| HEADLIGHT CASE | 0.3 | 1 | 33100-375-003 | HEADLIGHT ASSY. (12V 50/40W STANLEY) | 1 | | DK,DM,U |
| HEADLIGHT UNIT and its related parts | 0.2 | | 33100-392-601 | HEADLIGHT ASSY. (12V 50/40W STANLEY) | 1 | | E |
| HEADLIGHT ASSY./BULB | C.1 | 2 | 33101-300-043 | RIM, HEADLIGHT | - | | DK,DM,E,U |
| • MARKER LIGHT SOCKET | | 3 | 33103-346-670 | SCREW, BEAM ADJUST | 1 | | DK,DM,E,U |
| | | 4 | 33107-300-003 | SPRING, HEADLIGHT BEAM ADJUSTING | 1 | | DK,DM,E,U |
| | | 5 | 33117-001-023 | NUT, HEADLIGHT BEAM ADJUSTING | 1 | | DK,DM,E,U |
| | | 6 | 33120-375-003 | HEADLIGHT UNIT (STANLEY) | 1 | | DK,DM,E,U |
| | | 7 | 33125-087-761 | SCREW, UNIT HOLDER | 2 | | DK,DM,E,U |
| | | 8 | 33128-292-670 | NUT, UNIT HOLDER | 2 | | DK,DM,E,U |
| | | 9 | 33130-323-003 | SOCKET COMP., HEADLIGHT | 1 | | DK,DM,E,U |
| | | 10 | 33170-323-003 | SOCKET COMP., MARKER LIGHT | 1 | | DK,DM,E,U |
| | | 11 | 34902-259-000 | BULB, DASH (12V3.4W) | 1 | | E |
| | | | 34903-071-003 | BULB, MARKER LIGHT (12V 3W) (STANLEY) | 1 | | DK,DM,U |
| | | 12 | 61301-300-0208 | CASE, HEADLIGHT | 1 | | DK,DM,E,U |
| | | 13 | 61302-300-000 | COLLAR, HEADLIGHT CASE | 2 | | DK,DM,E,U |
| | | 14 | 61303-336-000 | WASHER, HEADLIGHT CASE | 2 | | DK,DM,E,U |
| | | 15 | 61304-292-000 | COLLAR, HEADLIGHT SETTING | 3 | | DK,DM,E,U |
| | | 16 | 92000-10025-08 | BOLT, HEX., 10X25 | 2 | | DK,DM,E,U |
| | | 17 | 93500-05016-08 | SCREW, PAN, 5X16 | 3 | | DK,DM,E,U |
| | | 18 | 94101-10200 | WASHER, PLAIN, 10MM | 2 | | DK,DM,E,U |
| | | 19 | 94111-05000 | WASHER, SPRING, 5MM | 3 | | DK,DM,E,U |
| | | 20 | 94111-10800 | WASHER, SPRING, 10MM | 2 | | DK,DM,E,U |
| | | 21 | 94251-05000 | PIN, LOCK, 5MM | 2 | | DK,DM,E,U |

1978.02.20

F-1-2

41

42

F 2