

L 7

F-8

Front brake caliper

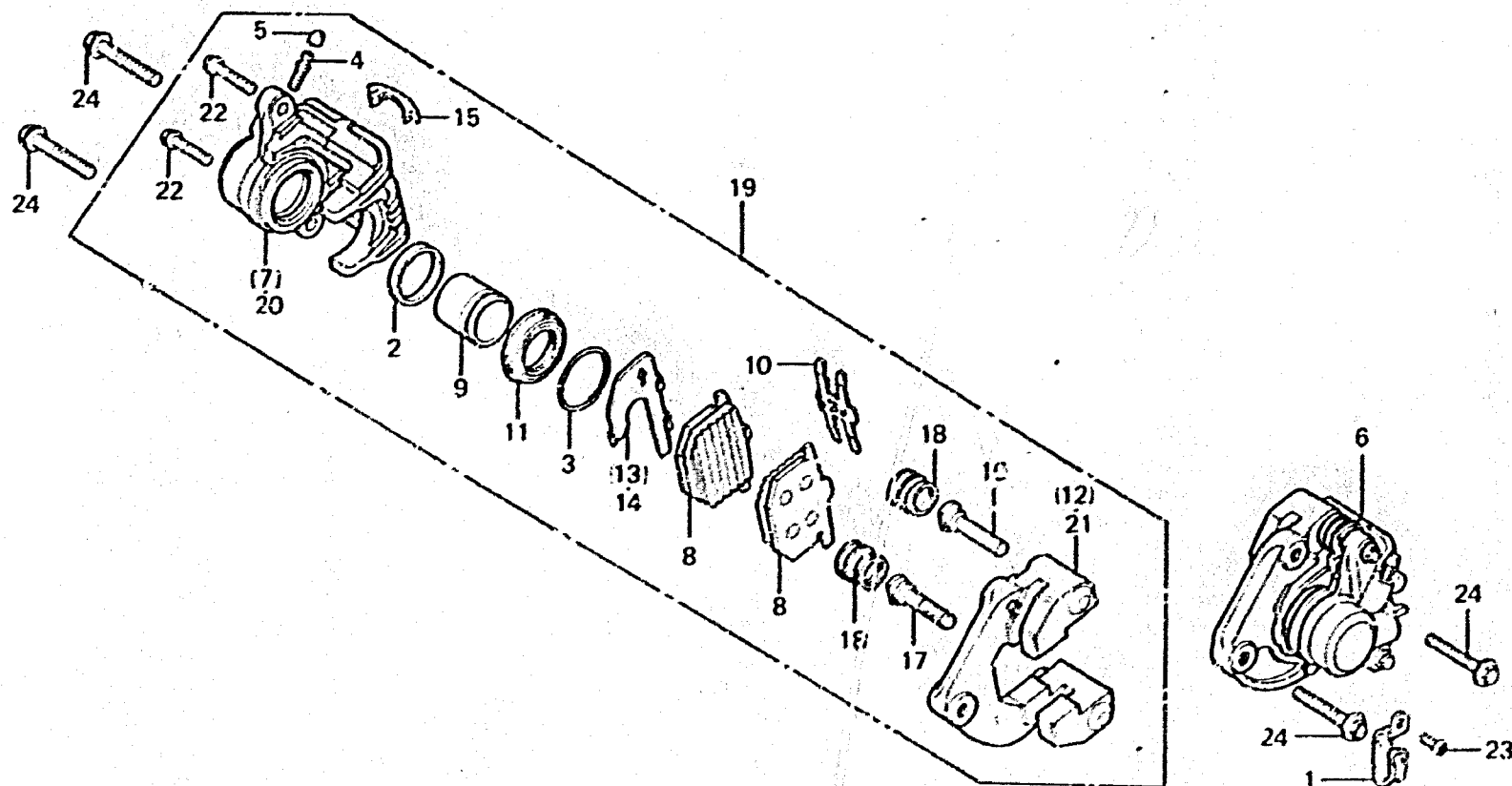

B410-14

Service item	F.R.T.	Ref. No.	Part No.	Description	Req'd. No. C3750 F2 F3	Serial No.	Area code
CALIPER/PISTON	0.4	1	32906-049-000	CLIP, HIGH TENSION CORD	1 1		
• One motorcycle 0.6		2	43209-371-006	SEAL, PISTON	2 2		
FRONT CALIPER ASSY.	0.3	3	43218-371-006	CLIP, DUST COVER	2 2		
• One motorcycle 0.4		4	43352-568-003	VALVE, BLEEDER	2 2		
FRONT BRACKET	0.2	5	43353-548-003	CAP, BLEED SCREW	2 2		
PAD COMP./PAD SPRING	0.1	6	45100-410-006	CALIPER ASSY., L. FR. (NISSHIN)	1 1		
		7	45101-410-006	CALIPER, L. (NISSHIN)	1 1		
		8	45105-410-006	PAD COMP. (NISSHIN)	4		
			45105-410-016	PAD COMP.	4	2206701	2206700
		9	45107-410-006	PISTON (NISSHIN)	2 2		
		10	45108-410-006	SPRING, PAD (NISSHIN)	2 2		
		11	45109-371-006	BOOT, PISTON	2 2		
		12	45110-410-006	BRACKET, L. FR. (NISSHIN)	1 1		
		13	45114-371-006	SHIM A, PAD	1 1		
		14	45116-371-006	SHIM B, PAD	1 1		
		15	45119-371-000	CAP, INDICATOR	2 2		
		16	45131-410-006	PIN A (NISSHIN)	2 2		
		17	45132-410-006	PIN B (NISSHIN)	2 2		
		18	45133-371-006	COVER, DUST	4 4		
		19	45200-410-006	CALIPER ASSY., R. FR. (NISSHIN)	1 1		
		20	45201-410-006	CALIPER, R. (NISSHIN)	1 1		
		21	45210-410-006	BRACKET, R. FR.	1 1		
		22	90116-410-006	BOLT, BX25 (NISSHIN)	4 4		

1978.09.10