

K 10

F-1-2

Headlight (E, ED, F, G)

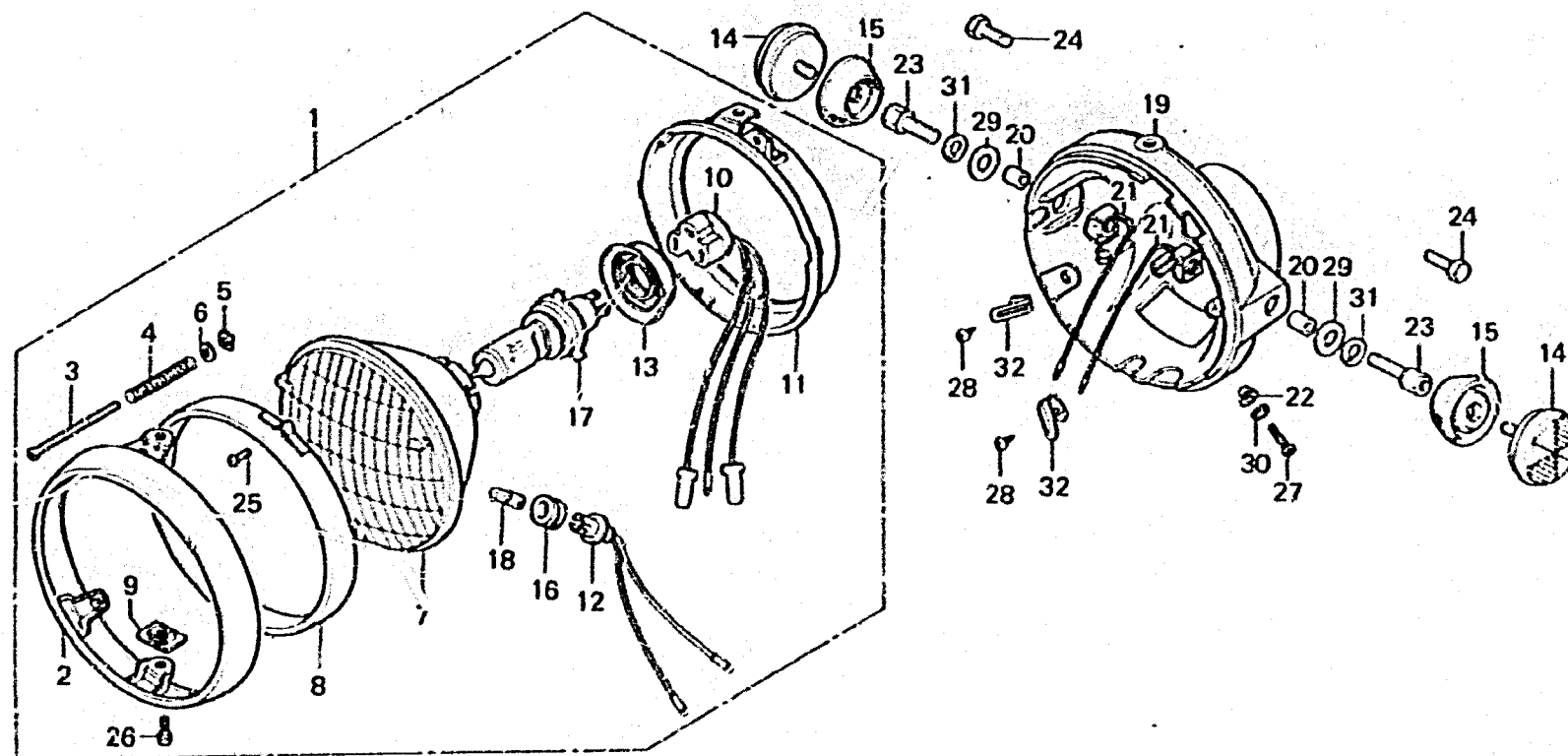

B410-38

Service item	F.R.T.	Ref. No.	Part No.	Description	Reqd. No. CB750 F2 F3	Serial No.	Area code
HEADLIGHT CASE	0.3	1	33100-371-601	HEADLIGHT ASSY.	1		E
SEALED BEAM UNIT and its related parts	0.2		33100-371-611	HEADLIGHT ASSY.	1		ED,F
HEADLIGHT ASSY./HEADLIGHT	0.1		33100-371-621	HEADLIGHT ASSY.	1		F
CORD SOCKET COMP.		2	33101-405-671	RING, HEADLIGHT	1		E,ED,F
		3	33103-346-670	SCREW, BEAM ADJUST	1		E,ED,F
		4	33107-300-093	SPRING, HEADLIGHT BEAM ADJUSTING	1		E,ED,F
		5	33117-001-023	NUT, HEADLIGHT BEAM ADJUSTING	1		E,ED,F
		6	33119-371-003	WASHER, BEAM ADJUST	1		E,ED,F
		7	33120-371-601	HEADLIGHT UNIT	1		E
			33120-371-611	HEADLIGHT UNIT	1		ED,F
		8	33121-405-671	RING, RETAINING	1		E,ED,F
		9	33128-292-670	NUT, UNIT HOLDER	2		E,ED,F
		10	33130-300-671	SOCKET COMP., HEADLIGHT CORD	1		E,ED,F
		11	33153-375-671	RING, MOUNTING	1		E,ED,F
		12	33170-390-611	SOCKET COMP., MARKER LIGHT	1		E,ED,F
		13	33180-371-601	COVER, BULB	1		E,ED,F
		14	33741-340-670	REFLECTOR, FR. COMPLEX	2		E,ED
		15	33743-375-000	BASE, FR. REFLECTOR	2		E,ED
		16	33905-371-601	RUBBER, JOINT	1		E,ED,F
		17	34901-371-601	H4 BULB(12342/99) MFD. BY PHILIPS (LOCAL PROCUREMENT PART)	1		E,ED
			34901-371-621	H4 BULB(12342/99) MFD. BY PHILIPS (LOCAL PROCUREMENT PART)	1		F
		18	34903-388-611	BULB, POSITION (12V 4W) (LOCAL PROCUREMENT PART)	1		E,ED,F
		19	61301-393-771ZA	CASE, HEADLIGHT 4NH-14	1		E,ED,F

1978.09.10