

K 9

F-1-1

Headlight (DK, DM, U)

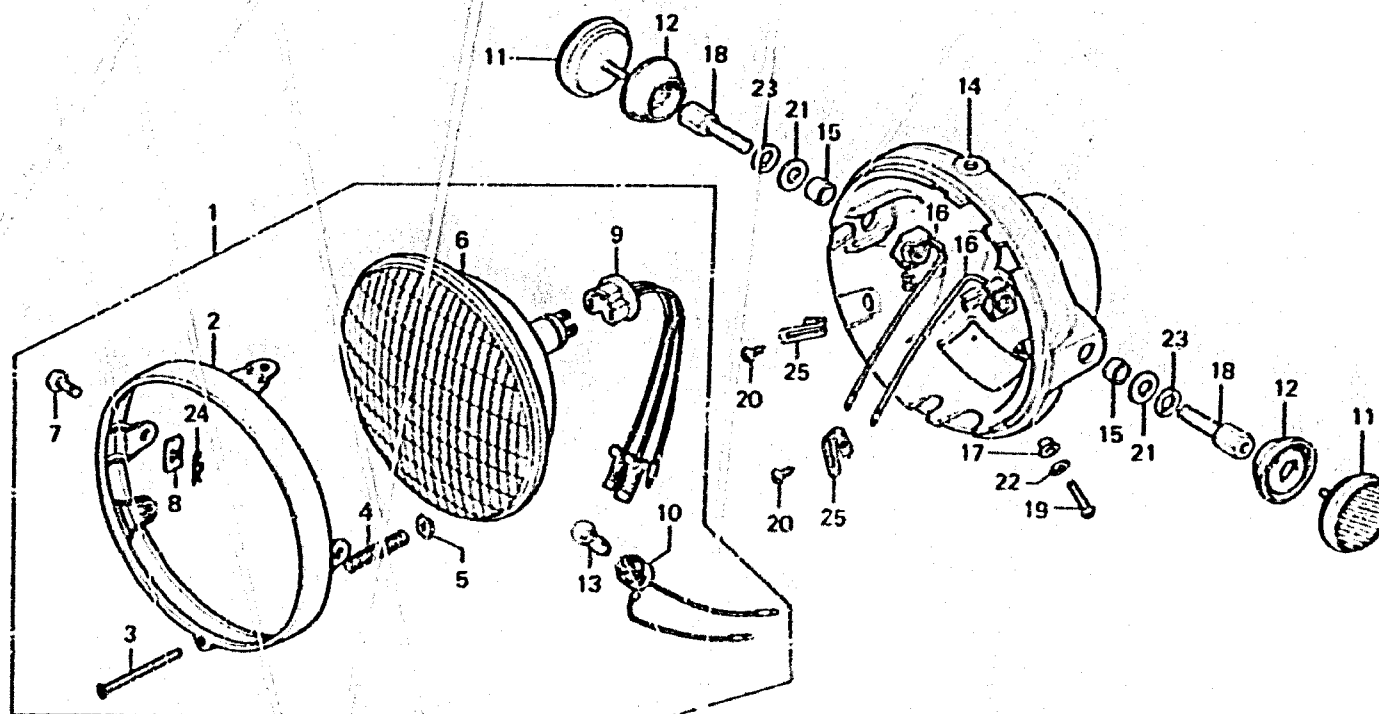

B410-35

Service item	F.R.T.	Ref. No.	Part No.	Description	Reqd. No. CB750 F2 F3	Serial No.	Area code
HEADLIGHT CASE	03	1	33100-375-003	HEADLIGHT ASSY. (12V 50/40W)	1		OK,DK,U
SEALED BEAM UNIT and its related parts	02	2	33101-300-043	RIM, HEADLIGHT	1		OK,DK,U
HEADLIGHT ASSY./HEADLIGHT CORD SOCKET COMP.	0.1	3	33103-346-670	SCREW, BEAM ADJUSTING	1		OK,DK,U
		4	33107-300-003	SPRING, HEADLIGHT BEAM ADJUSTING	1		OK,DK,U
		5	33117-001-023	NUT, HEADLIGHT BEAM ADJUSTING	1		OK,DK,U
		6	33120-375-003	HEADLIGHT UNIT	1		OK,DK,U
		7	33125-087-761	SCREW, UNIT HOLDER	2		OK,DK,U
		9	33128-292-670	NUT, UNIT HOLDER	2		OK,DK,U
		9	33130-323-003	SOCKET COMP., HEADLIGHT	1		OK,DK,U
		10	33170-323-003	SOCKET COMP., MARKER LIGHT	1		OK,DK,U
		11	33741-340-670	REFLECTOR, FR. REFLEX	2		OK,DK,U
		12	33743-375-000	BASE, FR. REFLECTOR	2		OK,DK,U
		13	34903-071-003	BULB, MARKER LIGHT (12V 3W) (STANLEY)	1		OK,DK,U
		14	61301-393-771ZA	CASE, HEADLIGHT 4NH-14	1		OK,DK,U
		15	61302-300-000	COLLAR, HEADLIGHT CASE	2		OK,DK,U
		16	61303-336-000	WASHER, HEADLIGHT CASE	2		OK,DK,U
		17	61304-292-000	COLLAR, HEADLIGHT SETTING	3		OK,DK,U
		18	90120-377-000	BOLT, HEADLIGHT STAY	2		OK,DK,U
		19	93500-05016-08	SCREW, PAN, 5X16	3		OK,DK,U
		20	93901-14110	SCREW, TAPPING, 4X8	3		OK,DK,U
		21	94101-10000	WASHER, PLAIN, 10MM	2		OK,DK,U
		22	94111-05000	WASHER, SPRING, 5MM	3		OK,DK,U
		23	94111-10000	WASHER, SPRING, 10MM	2		OK,DK,U
		24	94251-05000	PIN, LOCK, 3MM	2		OK,DK,U
		25	94591-45000	CLIP, WIRE, 4X50	3		OK,DK,U

1978.09.10