

I 14

E-10

Generator • Dynamo cover

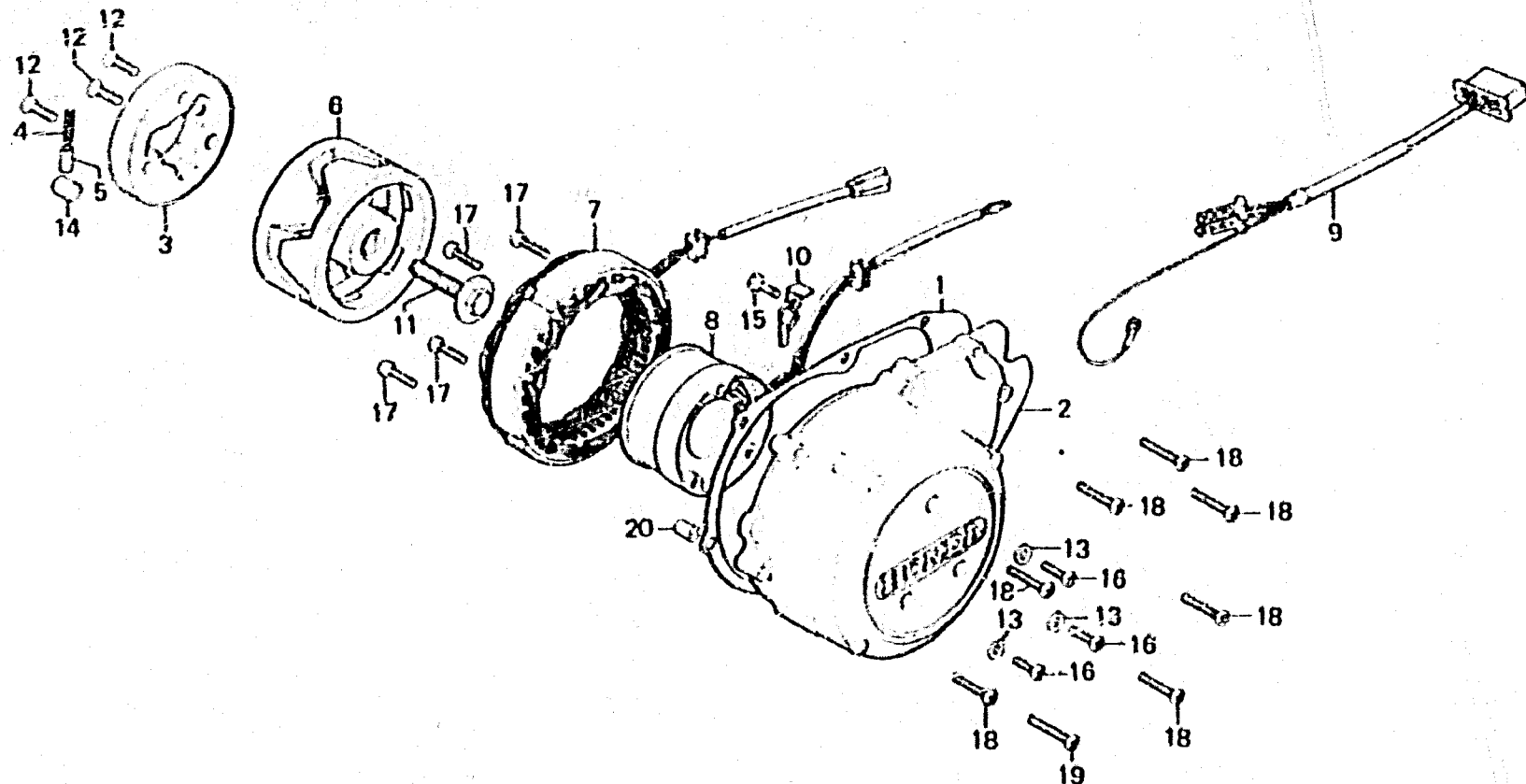

all-37

Service Item	F.R.T.	Ref. No.	Part No.	Description	Reqd. No. CB750 F2 F3	Serial No.	Area code
DYNAMO COVER/STATOR/FIELD COIL • ROTER/STARTING CLUTCH OUTER	0.6	1	11397-300-040	GASKET, DYNAMO COVER	1	1000030	E, ED, F, J
			11397-393-020	GASKET, DYNAMO COVER	1	2611642	A, CH, DK, DM, U
A.C. GENERATOR WIRE HARNESS • DYNAMO COVER GASKET	0.4				1	1000031	E, ED, F, J
					1	2611643	A, CH, DK, DM, U
		2	11631-410-010	COVER, DYNAMO	1		
		3	28120-300-000	OUTER, STARTING CLUTCH	1		
		4	28125-516-030	SPRING, STARTING CLUTCH ROLLER	3		
		5	28126-516-020	CAP, STARTING CLUTCH ROLLER SPRING	3		
		6	31101-300-035	ROTOR COMP. (HITACHI)	1		
		7	31102-300-035	STATOR COMP. (HITACHI)	1	1001006	E, ED, F, J
			31102-300-045	STATOR COMP. (HITACHI)	1	2611867	A, CH, DK, DM, U
					1	1001007	E, ED, F, J
					1	2611868	A, CH, DK, DM, U
		8	31103-300-035	COIL COMP., FIELD (HITACHI)	1		
			31103-300-045	COIL COMP., FIELD (HITACHI)	1	1001006	E, ED, F, J
					1	2611857	A, CH, DK, DM, U
					1	1001007	E, ED, F, J
					1	2611858	A, CH, DK, DM, U
		9	31110-300-015	HARNESS, A.C. GENERATOR WIRE (HITACHI)	1		
			31110-300-154	HARNESS, A.C. GENERATOR WIRE (SUMITOMO)	1		
		10	52116-300-010	PLATE, A.C. GENERATOR CORD SET	1		
		11	90014-392-010	BOLT, ROTOR SET	1		
		12	90053-300-000	SCREW, FLAT, BX22	3		

1478.09.10