

19

E-7

Contact breaker - Advancer

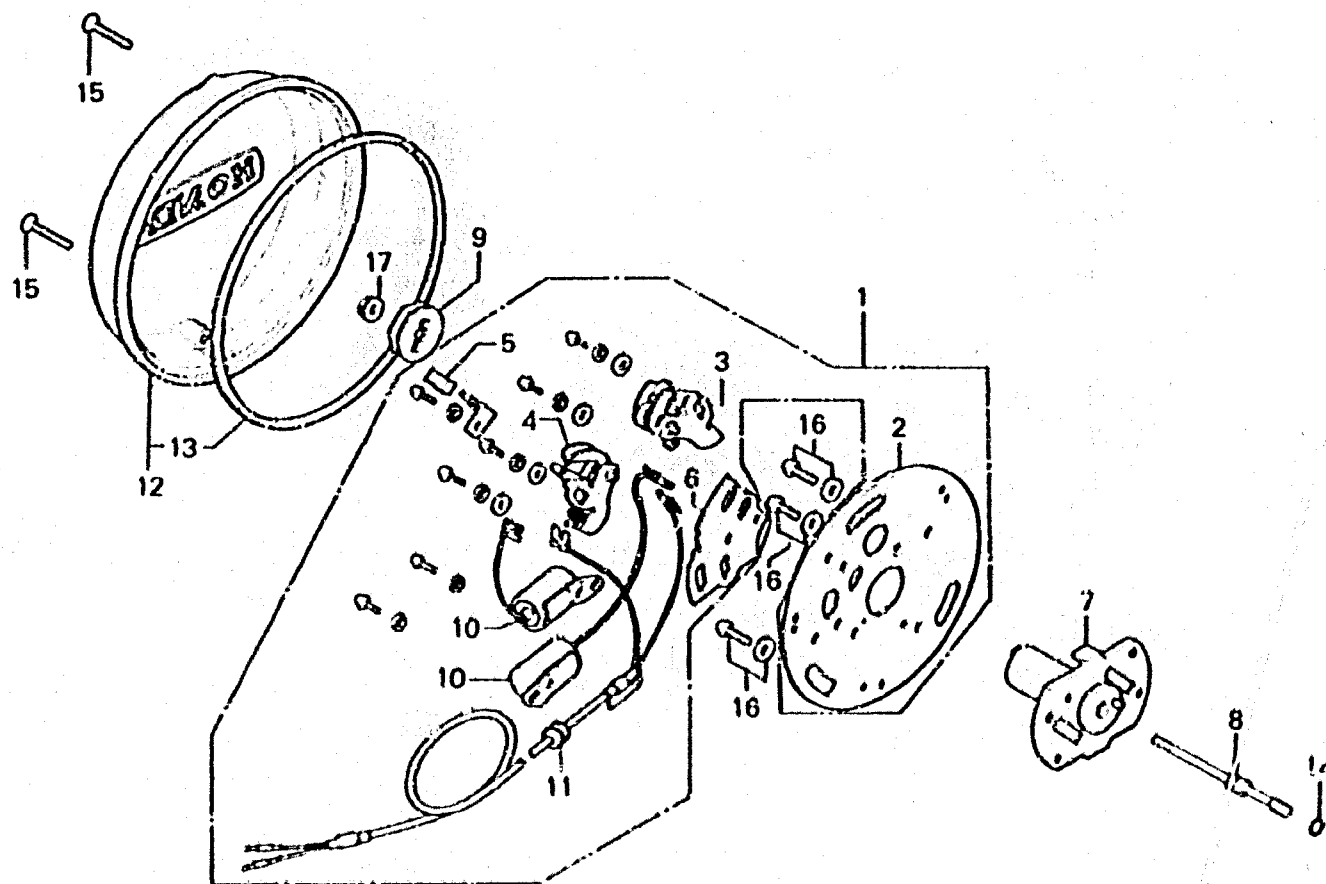

B405-5

Service item	F.R.T.	Ref. No.	Part No.	Description	Reqd. No. CB750 F2 F3	Serial No.	Area code
CONTACT BREAKER BASE PLATE	0.9	1	30200-300-015	BREAKER ASSY., CONTACT (HITACHI)	1	1	
CONTACT BREAKER/BREAKER SHIFT PLATE	0.6	2	30200-300-154	ADVANCER ASSY., CONTACT (TOYO)	1	1	
• Add 0.1			30201-300-015	PLATE, CONTACT BREAKER BASE (HITACHI)	1	1	
CONTACT BREAKER ASSY./SPARK ADVANCER ASSY.	0.5		30201-300-154	PLATE, CONTACT BREAKER BASE (TOYO)	1	1	
CONDENSER	0.3	3	30203-300-005	BREAKER, CONTACT (184 HITACHI)	1	1	
• Add 0.1			30203-300-154	BREAKER, CONTACT (184 TOYO)	1	1	
POINT COVER/OIL FELT	0.1	4	30204-300-005	BREAKER, CONTACT (283 HITACHI)	1	1	
			30204-300-154	BREAKER, CONTACT (283 TOYO)	1	1	
		5	30205-003-001	FELT, OIL (HITACHI)	1	1	
			30205-300-154	FELT, OIL (TOYO)	1	1	
		6	30215-300-001	PLATE, BREAKER SHIFT (HITACHI)	1	1	
			30215-300-154	PLATE, BREAKER SHIFT (TOYO)	1	1	
		7	30220-300-005	ADVANCER ASSY., SPARK (HITACHI)	1	1	
			30220-300-154	ADVANCER ASSY., SPARK (TOYO)	1	1	
		8	30231-300-010	SHAFT, SPARK ADVANCER	1	1	
		9	30233-300-000	WASHER, SPECIAL	1	1	
		10	30250-300-005	CONDENSER COMP. (HITACHI)	2	2	
			30250-300-154	CONDENSER COMP. (TOYO)	2	2	
		11	30254-300-100	GROMMET, PRIMARY CORD	1	1	
		12	30370-300-020	COVER COMP., POINT	1	1	
		13	30372-300-300	GASKET, POINT COVER	1	1	
		14	91301-300-000	O-RING	1	1	
		15	93700-06032-02	SCREW, OVAL, 6X32	2	2	

1978.09.10