

E-19 Carburetor (KEIHIN)

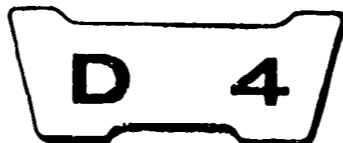

E-19 Carburetor (KEIHIN)

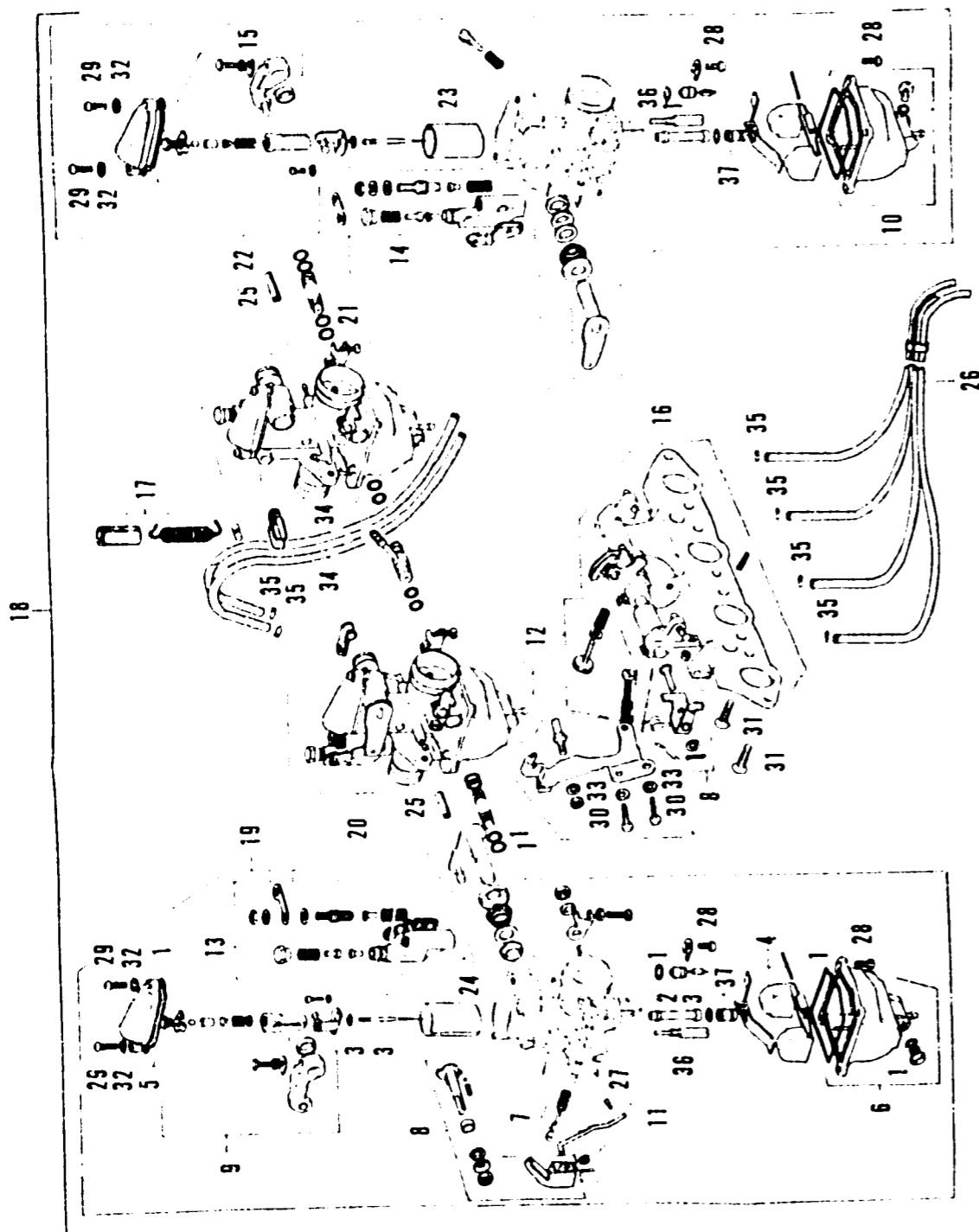

Ref. No.	Part No.	Description	Reqd. No. CR350 F F1	Serial No.	Area code
1	16010-333-004	GASKET SET	4 4		
2	16011-329-004	VALVE SET, FLOAT	4 4		
3	16012-333-004	NEEDLE SET, JET	4 4		
4	16013-333-004	FLOAT SET	4 4		
5	16014-333-004	TOP SET	4 4		
6	16015-333-004	CHAMBER SET A, FLOAT	2 2		
7	16016-333-004	SCREW SET A	4 4		
8	16017-333-004	LINK SET	1 1		
9	16016-333-004	ARM SET, LINK	2 2		
10	16023-333-004	CHAMBER SET B, FLOAT	2 2		
11	16025-333-004	ROD SET, CHOKE	1 1		
12	16028-333-004	SCREW SET B	1 1		
13	16029-323-004	HOLDER SET A, ADJUST	2 2		
14	16030-323-004	HOLDER SET B, ADJUST	2 2		
15	16031-333-004	ARM SET B, LINK	2 2		
16	16035-333-004	PLATE SET, STAY	1 1		
17	16036-323-004	TUBE SET, PROTECT	1 1		
18	16100-333-004	CARBURETOR ASSY. (KEIHIN)	1 1		
19	16101-333-004	CARBURETOR ASSY. A	1 1		
20	16102-333-004	CARBURETOR ASSY. B	1 1		
21	16103-333-004	CARBURETOR ASSY. C	1 1		
22	16104-333-004	CARBURETOR ASSY. D	1 1		
23	16111-333-004	VALVE A, THROTTLE	2 2		
24	16112-333-004	VALVE B, THROTTLE	2 2		
25	16199-333-004	TUBE, FUEL, 2.5X16	2 2		
26	16290-333-000	TUBE, OVER FLOW	1 1		
27	93500-03006-0A	SCREW, PAN, 3X6	1 1		
28	93500-04010-0A	SCREW, PAN, 4X10	20 20		
29	93500-05016-0A	SCREW, PAN, 5X16	8 8		
30	93500-06016	SCREW, PAN, 6X16	2 2		
31	9700-06016	SCREW, FLAT, 6X16	8 8		
32	94111-05000	WASHER, SPRING, 5MM	8 8		
33	94111-06000	WASHER, SPRING, 6MM	2 2		
34	95001-35600-40	TUBE, FUEL, 3.5X600	2 2		
35	95002-02070	CLIP B7, TUBE	6 6		
36	99124-076-0350	JET, SLOW (#35)	4 4		
	99124-076-0380	JET, SLOW, #38	(4)(4)		
37	99202-601-0680	JET SET, MAIN (#68)	(4)(4)		
	99202-601-0700	JET SET, MAIN (#70)	(4)(4)		
	99202-601-0720	JET SET, MAIN (#72)	(4)(4)		
	99202-601-0750	JET SET, MAIN (#75)	4 4		
	99202-601-0780	JET SET, MAIN (#78)	(4)(4)		
	99202-601-0800	JET SET, MAIN (#80)	(4)(4)		