

F-26 Frame Body

G 10

F-26 Frame Body

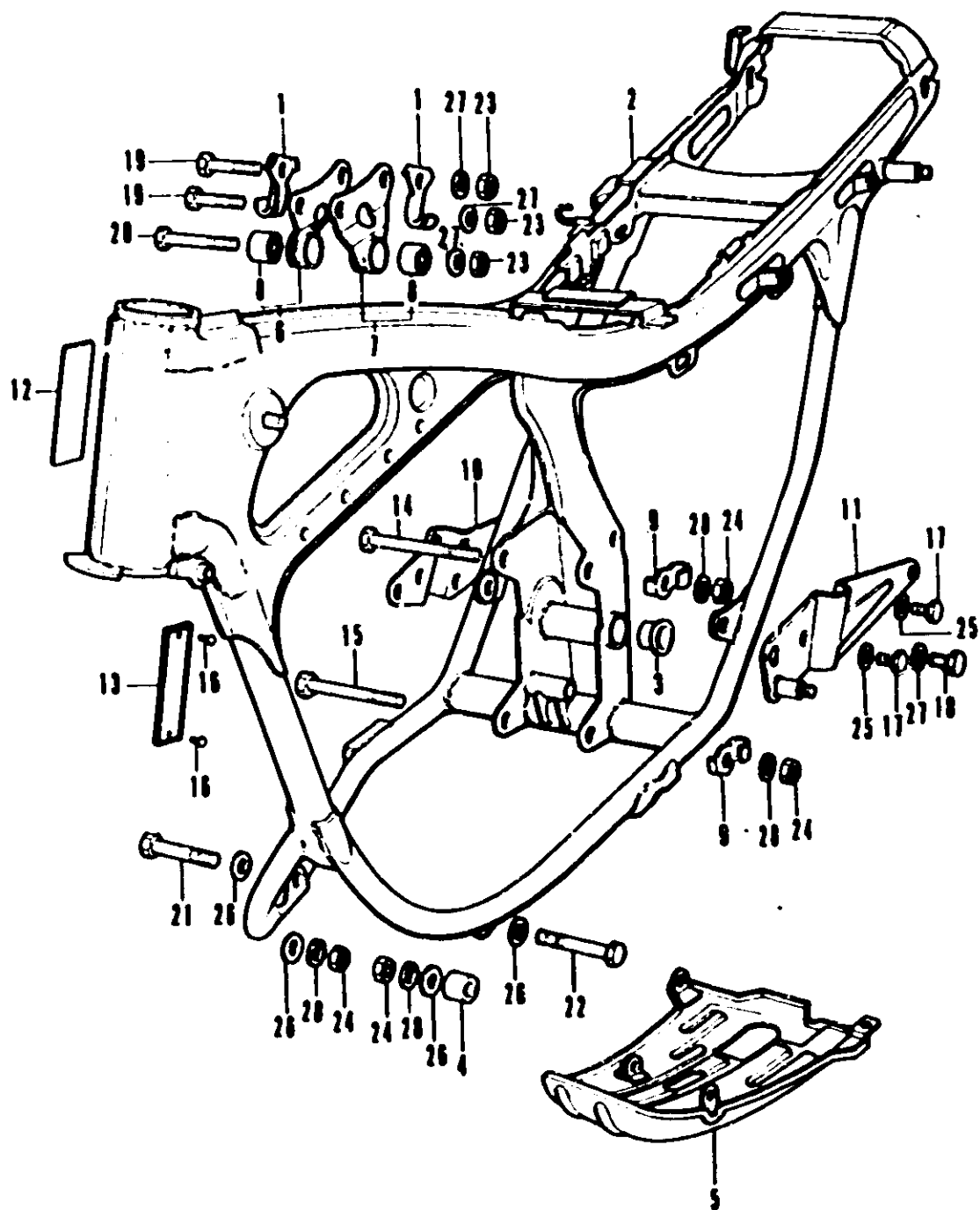

Ref. No.	Part No.	Description	Reqd. No.				Serial No	Area code
			CB250 B4 K4	CB350 B4 K4	CL350 P4 K4			
13	87501-344-640	PLATE, REGISTERED NUMBER		1			r	
	87501-344-710	PLATE, REGISTERED NUMBER		1			II	
	87501-348-690	PLATE, REGISTERED NUMBER	1				r	
	87501-348-710	PLATE, REGISTERED NUMBER	1				FD	
	87501-344-610	PLATE, REGISTERED NUMBER			1		r	
	87501-344-620	PLATE, REGISTERED NUMBER			1		r	
	87501-344-630	PLATE, REGISTERED NUMBER			1		II	
	87501-344-730	PLATE, REGISTERED NUMBER			1		FD	
	87501-348-610	PLATE, REGISTERED NUMBER	1				r	
	87501-348-620	PLATE, REGISTERED NUMBER	1				r	
	87501-348-730	PLATE, REGISTERED NUMBER	1				En	
14	50102-286-000	BOLT, ENGINE HANGER	1	1	1	1	1	
15	90103-286-000	BOLT, ENGINE HANGER	1	1	1	1	1	
16	50841-001-000	SCREW, DIM: 1.5X5	1	1	1			
17	92000-06012	BOLT, HEX: 6X12	4	4	4	4	4	
18	92000-08016-0A	BOLT, HEX: 8X16	2	2	2	2	2	
19	92000-08040-0A	BOLT, HEX: 8X40	2	2	2	2	2	
20	92000-08085-0A	BOLT, HEX: 8X85	1	1	1	1	1	
21	92200-10050-0A	BOLT, HEX: 10X50	1	1	1		1	
22	92200-10063-0A	BOLT, HEX: 10X63	1	1	1		1	
23	94001-08000-05	NUT, HEX: 8PP	3	3	3	3	3	
24	94001-10000-05	NUT, HEX: 10PP	4	4	4	2	4	
25	94101-06000	WASHER, PLAIN: 6PP	4	4	4	4	4	
26	94101-10000	WASHER, PLAIN: 10PP	4	4	4	4	4	
27	94111-08000	WASHER, SPRING: 8PP	6	6	6	6	6	
28	94111-10000	WASHER, SPRING: 10PP	4	4	4	2	4	

FIG. 11

FIG. 11