

F-18 Wire Harness - Battery

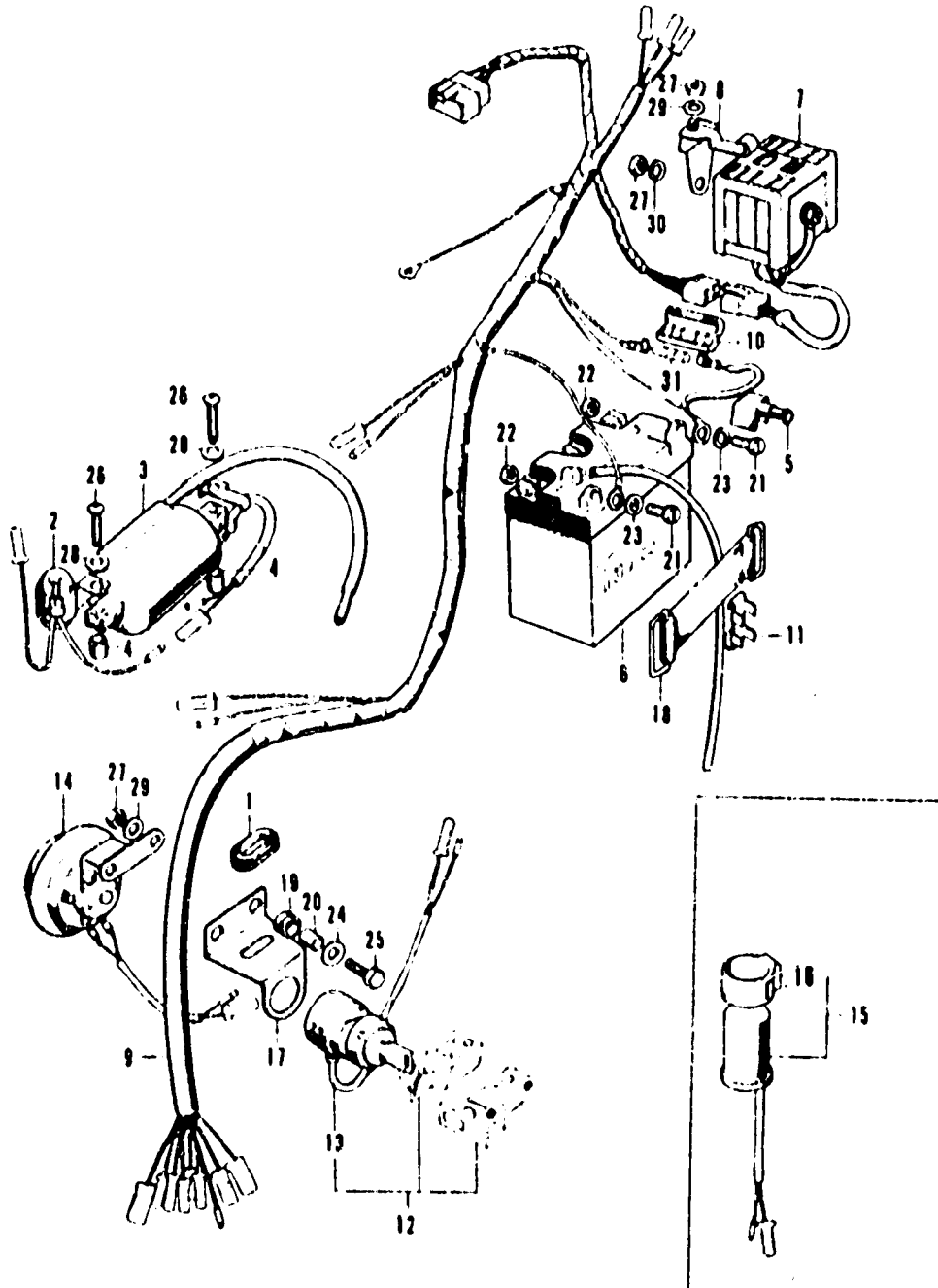

F-18 Wire Harness - Battery



Ref. No.	Part No.	Description	Reqd. No.		Serial No.	Area Code
			SL125	KL K2		
1	17247-240-000	GROMMET A; AIR CLEANER CASE	1	1		
2	30250-107-000	CONDENSER ASSY.	1	1		
3	30400-107-007	COIL COMP.; IGNITION	1	1		
4	30507-107-000	COLLAR; IGNITION COIL SETTING	2	2		
5	31468-107-000	COVER; BATTERY TERMINAL	1	1		
6	31500-110-671	BATTERY ASSY.	1	1		A
	31500-324-601	BATTERY ASSY.	1			D;E;F;G
7	31701-107-701	RECTIFIER COMP.; SELENIUM	1	1		
8	31707-331-770	STAY COMP.; SELENIUM RECTIFIER	1	1		
9	32100-110-710	HARNESS; WIRE	1			D;F
	32100-331-610	HARNESS; WIRE	1			G
	32100-331-771	HARNESS; WIRE 32100-331-610	1			A
	32100-331-610	HARNESS; WIRE	1			F
10	32111-230-000	CASE; FUSE CONNECTOR	1	1		
11	32113-107-000	HOLDER; FUSE	1	1		
12	35030-110-781	SWITCH KIT; MAIN	1	1		A;D;E;F;G
	35030-331-611	SWITCH KIT; MAIN	1			G
13	35100-111-671	SWITCH; MAIN	1	1		
14	38100-110-671	HORN ASSY.	1	1		A;D;E;F;G
	38100-331-621	HORN ASSY.	1			F
15	38300-107-004	RELAY ASSY.; WINKER (MITURA)	1			D;F
	38300-107-601	RELAY ASSY.; WINKER	1			E;G
16	38306-292-000	SUSPENSION; WINKER RELAY	1			D;E;F;G
17	50375-331-000	BRACKET; MAIN SWITCH	1	1		
18	83601-307-000	BAND; BATTERY 95012-15000	1	1		
	95012-15000	BAND O; BATTERY	1	1		
19	84705-292-000	RUBBER; NUMBER BRACKET CUSHION	2	2		
20	84706-286-000	COLLAR; NUMBER BRACKET SFT	2	2		
21	90122-107-000	BOLT; BATTERY TERMINAL	2	2		
22	90306-107-000	NUT; BATTERY TERMINAL	2	2		
23	90501-107-000	WASHER; BATTERY TERMINAL	2	2		
24	90525-030-000	WASHER B; HANDLE HOLOFP SETTING	2	2		
25	92000-06025	BOLT; HEX.; 6x25	2	2		
26	93500-05028-4 J	SCREW; PAN; 5x28	2	2		
27	94001-06000	NUT; HEX.; 6MM	4	4		
28	94101-05000	WASHER; PLAIN; 5MM	2	2		
29	94101-06000	WASHER; PLAIN; 6MM	3	3		
30	94111-06000	WASHER; SPRING; 6MM	1	1		
31	98200-11000	FUSE; 10A	1			D
	98200-11500	FUSE; 15A	1	1		A;E;F;G