

E-10 Gear Shift

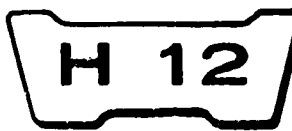

E-10 Gear Shift

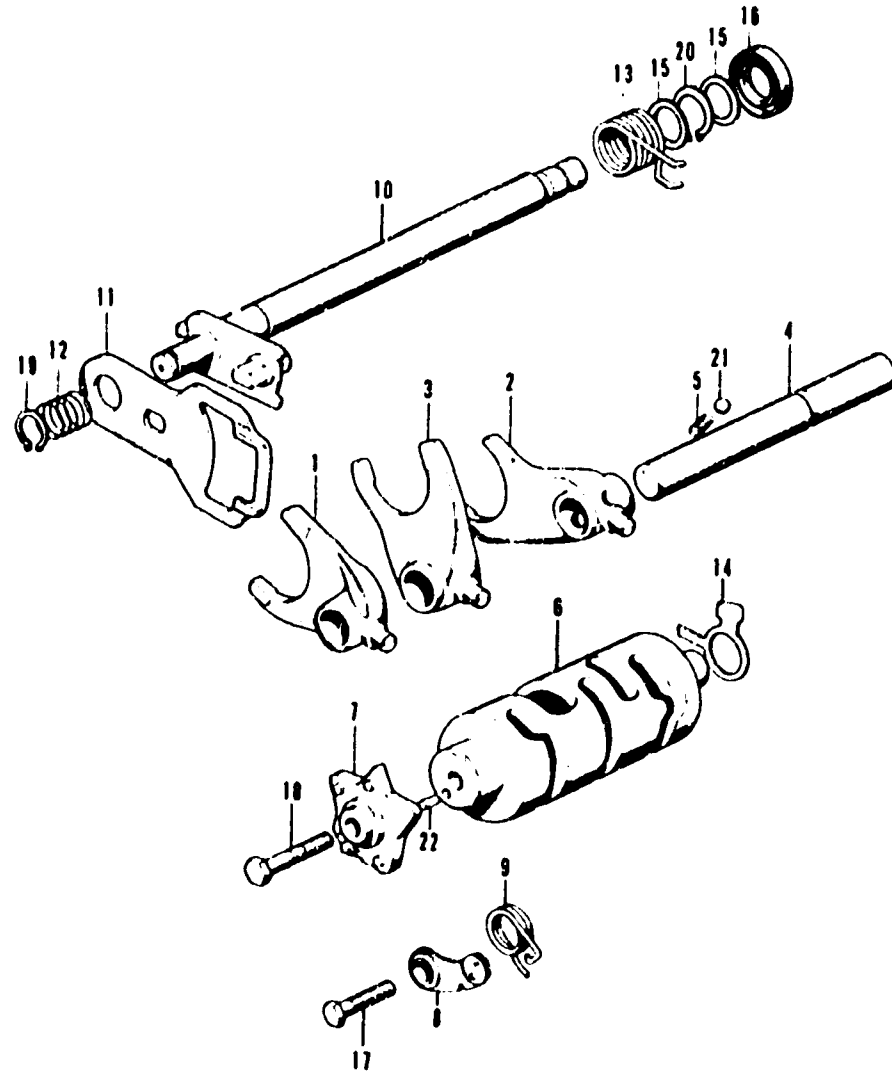

Ref. No.	Part No.	Description	Reqd. No.		Serial No.	Area Code
			SL125	K1 K2		
1	24211-107-000	FORK, R. GEAR SHIFT	1	1		
2	24221-107-000	FORK, L. GEAR SHIFT	1	1		
3	24231-107-000	FORK, CENTER GEAR SHIFT	1	1		
4	24241-107-000	SHAFT, GEAR SHIFT FORK GUIDE	1	1		
5	24271-107-000	SPRING, BALL SET	1	1		
6	24301-107-000	DRUM, GEAR SHIFT	1	1		
7	24411-107-000	CAM, GEARSHIFT	1	1		
8	24410-324-000	STOPPER COMP., GEAR SHIFT DRUM	1	1		
9	24435-107-761	SPRING, SHIFT DRUM STOPPER	1	1		
10	24610-107-760	SPINDLE COMP., GEAR SHIFT	1	1		
11	24621-107-760	PLATE, GEAR SHIFT	1	1		
12	24631-107-000	SPRING, GEAR SHIFT PLATE	1	1		
13	24651-107-000	SPRING, GEAR SHIFT RETURN	1	1		
14	35753-028-601	ROTOR, NEUTRAL SWITCH	1	1		
15	90451-001-000	WASHER, THRUST, 14MM	2	2		
16	91206-286-013	OIL SEAL, 14X28X7 (ARAI)	1	1		
17	92000-06020	BOLT, HEX., 6X20	1	1		
18	92000-06025	BOLT, HEX., 6X25	1	1		
19	94510-12000	CIR CLIP, EXTERNAL, 12MM	1	1		
20	94510-14000	CIR CLIP, EXTERNAL, 14MM	1	1		
21	96211-08000	BALL, STEEL, #8	1	1		
22	96220-40100	ROLLER, 4X10	1	1		

B110-57