

E-2 Contact Breaker • Spark Advancer

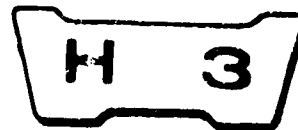

E-2 Contact Breaker • Spark Advancer

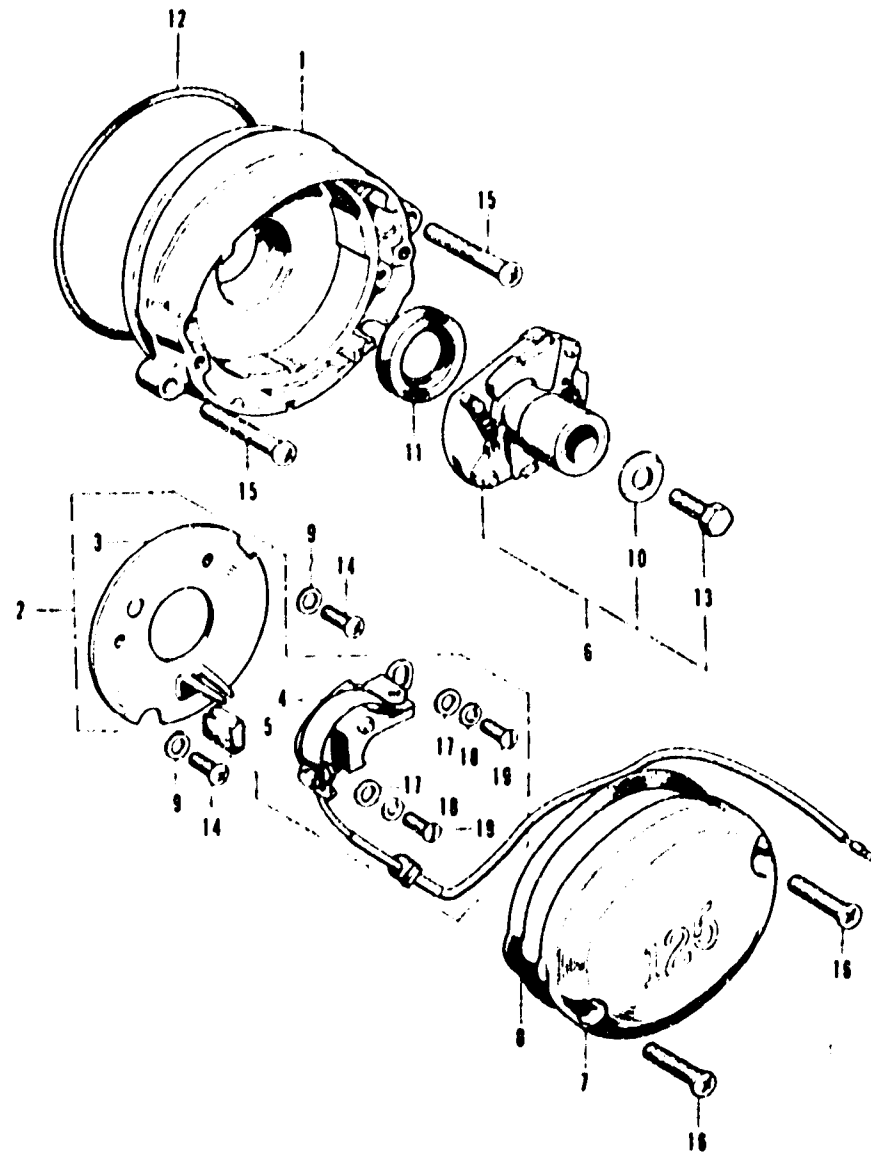

Ref. No.	Part No.	Description	Reqd. No. SL125 61 K2	Serial No.	Area Code
1	12332-324-000	BASE, CONTACT BREAKER	1	1	
2	30200-107-014	BREAKER ASSY., CONTACT (ND)	1	1	
	30200-107-154	BREAKER ASSY., CONTACT (TOYO)	1	1	
3	30201-107-004	PLATE, CONTACT BREAKER BASE (ND)	1	1	
	30201-107-154	PLATE, CONTACT BREAKER BASE (TOYO)	1	1	
4	30202-107-004	BREAKER, CONTACT (ND)	1	1	
	30202-107-154	BREAKER, CONTACT (TOYO)	1	1	
5	30205-028-004	FEELER OIL (ND)	1	1	
	30205-300-154	FEELER OIL (TOYO)	1	1	
6	30220-107-004	ADVANCER ASSY., SPARK (ND)	1	1	
	30220-107-154	ADVANCER ASSY., SPARK (TOYO)	1	1	
7	30370-324-000	COVER, CONTACT BREAKER	1	1	
8	30372-107-000	GASKET, CONTACT BREAKER COVER	1	1	
9	90482-028-000	WASHER, 5MM	2	2	
10	90486-028-000	WASHER, SPARK ADVANCER FITTING	1	1	
11	91202-107-000	OIL SEAL, 15X25X7 91202-107-003	1	1	
12	91301-107-000	O-RING, 75X2.5	1	1	
13	92000-06014	BOLT, HEX., 6X14	1	1	
14	93500-05012-0A	SCREW, PAN, 5X12	2	2	
15	93500-06025	SCREW, PAN, 6X25	2	2	
16	93700-05020-0B	SCREW, OVAL, 5X20	2	2	
17	94101-04000	WASHER, PLAIN, 4MM	2	2	
18	94111-04000	WASHER, SPRING, 4MM	2	2	
19	99500-04007-0A	SCREW, HOLLOW PAN, 4X7	2	2	

B110 2