

If a Fuse Blows

Main Fuses Access

1. To prevent an accidental short circuit, turn the ignition switch to OFF (w) before checking or replacing the fuses.
2. Remove the seat (page 130).
3. Remove the rear fender cover (page 131).
4. To access the main fuse 1 (2), remove the fuse cover (3).
5. To access the main fuse 2 (4), remove the fuse box cover (5).

UNDER REAR FENDER COVER

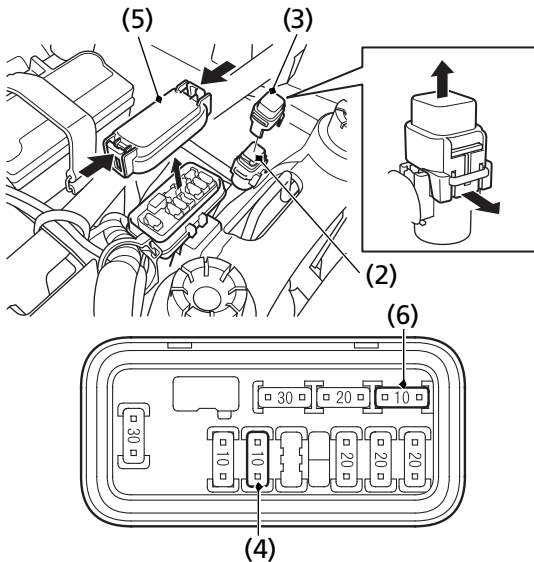

- (2) main fuse 1
(3) fuse cover
(4) main fuse 2

- (5) fuse box cover
(6) spare fuse

6. Pull the main fuses out.
If the main fuse 1 is blown, install the spare fuse (page 129).
If the main fuse 2 is blown, install the spare fuse (6).
7. Install the fuse cover.

(cont'd)