

Gear Case Oil

1. Park the ATV on level ground.
2. Place an oil drain pan under the oil drain plug (1).
3. Remove the oil fill cap (2) and the drain plug.
4. After the oil has completely drained, reinstall the drain plug and tighten it to the specified torque:
9 lbf·ft (12 N·m , 1.2 kgf·m)
5. Pour the drained oil into a suitable container and dispose of it in an approved manner (page 160).

NOTICE

Improper disposal of drained fluids is harmful to the environment.

6. Fill the gear case with the recommended oil.
2.7 US oz (80 cm³)
7. Remove the oil level check bolt (3). Make sure the oil level reaches the oil level check hole (4).
8. Install the oil fill cap and oil level check bolt.

REAR

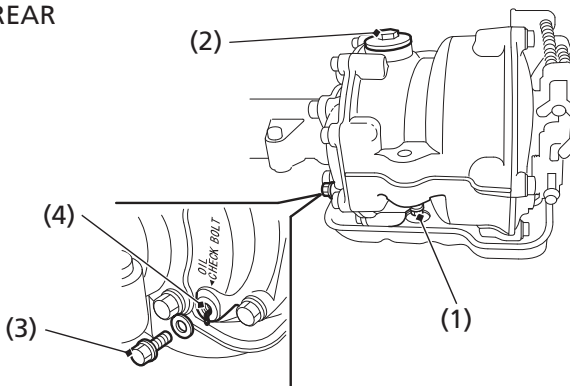

- | | |
|--------------------|--------------------------|
| (1) oil drain plug | (3) oil level check bolt |
| (2) oil fill cap | (4) oil level check hole |