

## Brake Light Switch Adjustment

Refer to *Safety Precautions* on page 105.

Periodically check the operation of the brake light switch. It is located under the air guide plate (page 120) in the front hood, just above -- and slightly behind -- the brake fluid reservoir.

The brake light should turn on just before the brake works. Adjustment is done by holding the switch body and turning the adjusting nut. Turn the nut in direction (A) if the switch operates too late, and in direction (B) if the switch operates too soon.

### UNDER FRONT HOOD LEFT SIDE

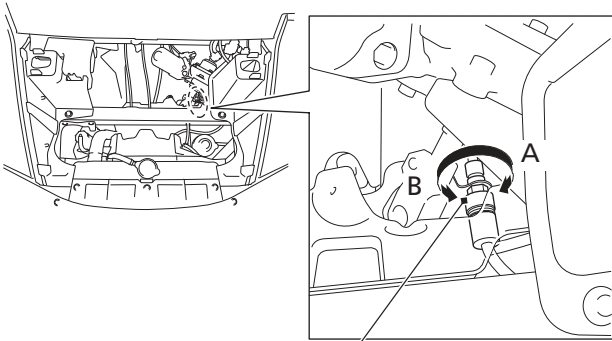

brake light switch