

# Storage Equipment

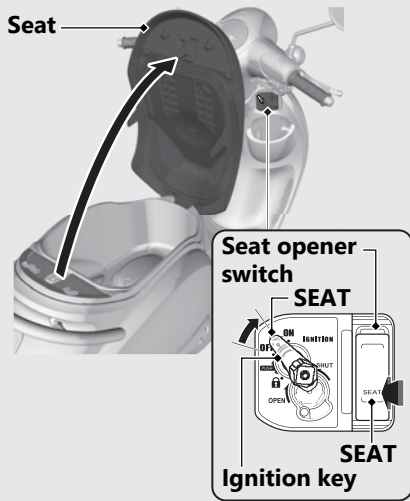

## To open the seat

- 1 Turn the handlebar pointed straight ahead.
- 2 Insert the ignition key and turn it to the position of SEAT.
- 3 Push the SEAT side of the seat opener switch.
- 4 Open the seat.

## To close the seat

Close and push down on the rear of the seat until it locks. Make sure that the seat is locked securely by pulling it up lightly. Take care not to lock your key in the compartment under the seat.