

5. Install the setting rubber (5), clamp (6) and bolt (7) by aligning the clamp tab (8) with the groove (9) of the stay.
Tighten the bolt securely.

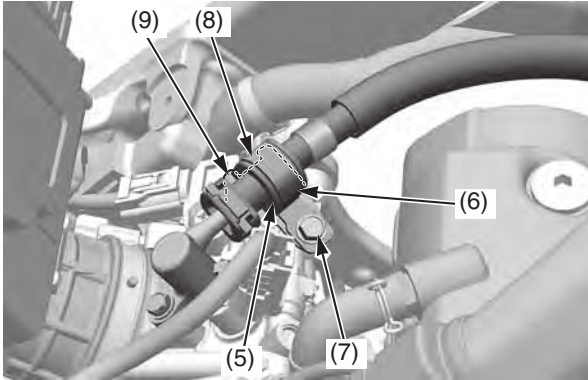

- (5) setting rubber
- (6) clamp
- (7) bolt
- (8) clamp tab
- (9) groove

6. Install the fuel tank (page 47).
7. Increase the fuel pressure (page 62).

Fuel Pump Filter Replacement

Empty the fuel tank into an approved gasoline container using a commercially available hand siphon or an equivalent method.
Be careful not to damage the fuel pump while draining the fuel in the fuel tank.

⚠ WARNING

Gasoline is highly flammable and explosive. You can be burned or seriously injured when handling fuel.

- Stop the engine and keep heat, sparks and flame away.
- Handle fuel only outdoors.
- Wipe up spills immediately.

Removal

1. Remove the fuel tank (page 45).
2. Remove the fuel pump mounting nuts (1), fuel pump mounting cap nut (2), stopper cable guide (3), washer (4), collars (5), conical spring washers (6) and fuel pump plate (7) while holding the fuel tank.

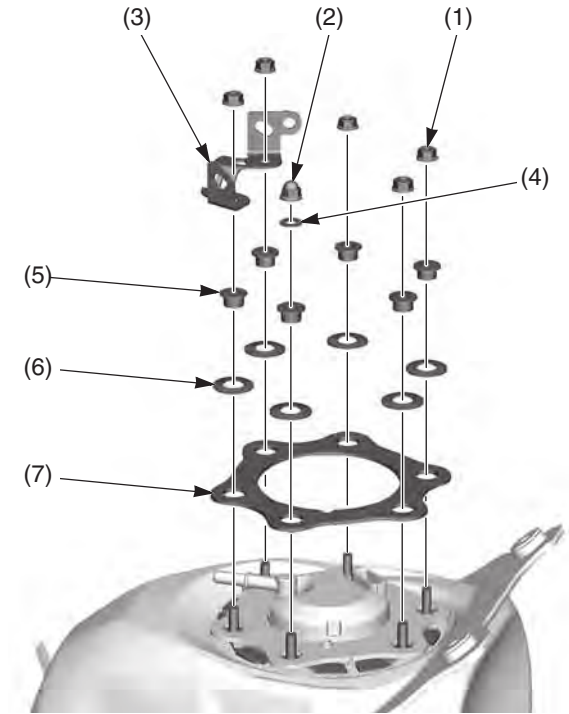

- (1) fuel pump mounting nuts
- (2) fuel pump mounting cap nut
- (3) stopper cable guide
- (4) washer
- (5) collars
- (6) conical spring washers
- (7) fuel pump plate

(cont'd)