

Torque Specifications

Frame

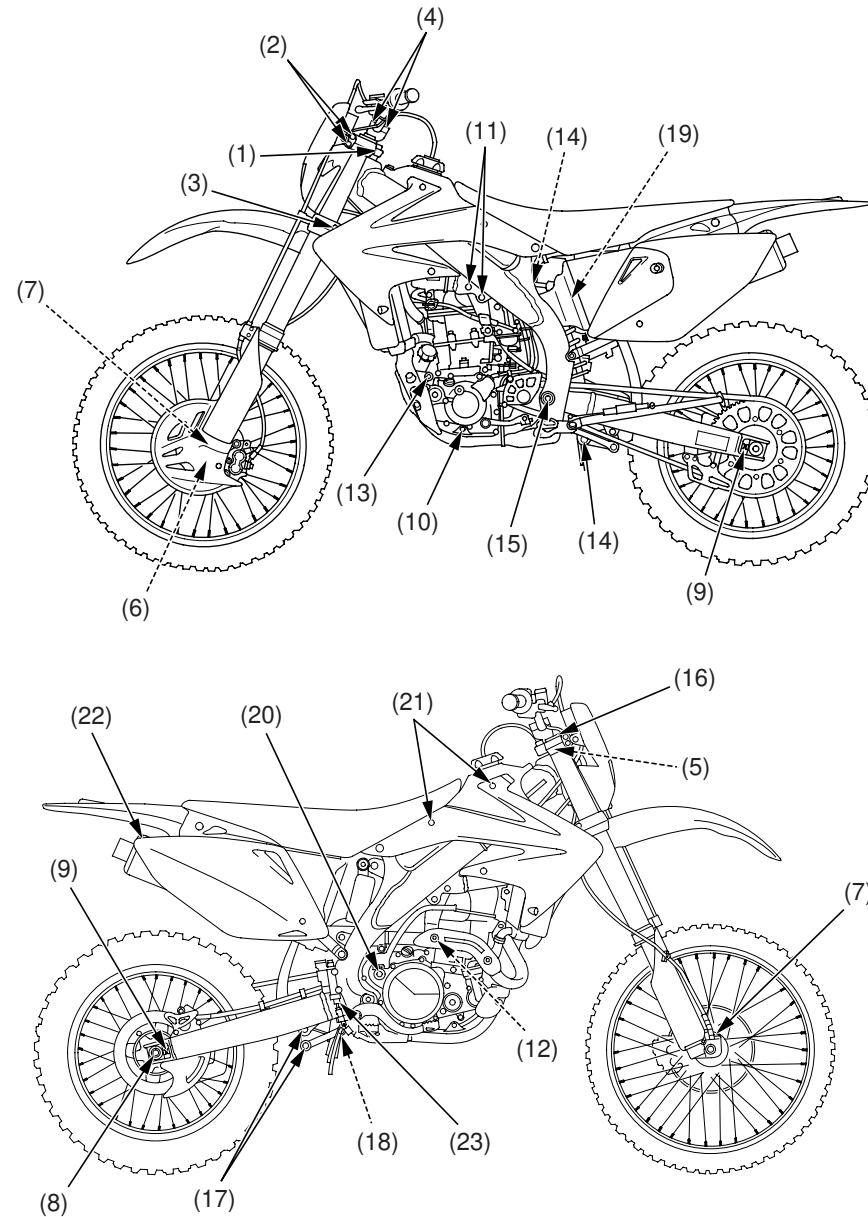

Item	Torque			Remarks	
	N·m	kgf·m	lbf·ft		
FRAME					
1	Steering stem nut	108	11.0	80	
2	Top bridge upper pinch bolts	22	2.2	16	
3	Bottom bridge lower pinch bolts	20	2.0	15	
4	Handlebar upper holder bolts	22	2.2	16	
5	Handlebar lower holder nuts	44	4.5	32	
6	Front axle nut	88	9.0	65	
7	Axle pinch bolts	20	2.0	15	
8	Rear axle nut	128	13.1	94	NOTE 2
9	Chain adjuster lock nuts	27	2.8	20	NOTE 3
10	Lower engine mounting nut	54	5.5	40	
11	Upper engine hanger plate bolts	26	2.7	19	
12	Upper engine hanger nut	54	5.5	40	
13	Front engine mounting nut	54	5.5	40	
14	Shock absorber (upper)	44	4.5	32	NOTE 2
	(lower)	44	4.5	32	NOTE 2
15	Swingarm pivot nut	88	9.0	65	NOTE 2
16	Fork (fork damper)	34	3.5	25	
	(fork cap)	30	3.1	22	
17	Rear shock arm nuts (swingarm side)	53	5.4	39	NOTE 1, 2
	(shock link side)	53	5.4	39	NOTE 1, 2
18	Rear shock link nuts	53	5.4	39	NOTE 1, 2
19	Shock spring lock nut	44	4.5	32	
20	Kickstarter arm bolt	38	3.9	28	
21	Shroud mounting bolts (upper)	5	0.5	3.7	
22	Spark arrester mounting bolts	12	1.2	9	
23	Brake pedal adjuster lock nut	5.9	0.6	4.4	

- NOTES:
1. Apply oil to the threads and flange surface.
 2. U-nut.
 3. UBS nut.
 4. SH bolt.
 5. Apply locking agent to the threads.