

Storing Your Honda

9. Install the centre engine guard (4) while aligning its tabs (10) with the grooves (11) of the radiator reserve tank. Install the centre engine guard mounting bolts and collars (3), then tighten them. Install the right engine guard (2) and tighten the bolt (1).

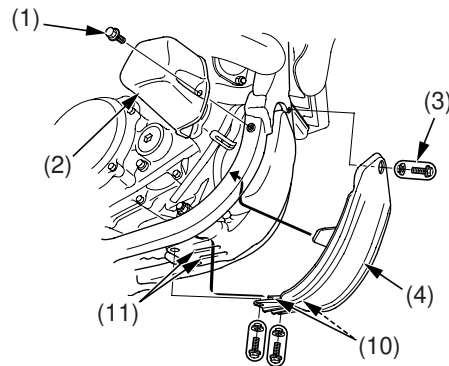

- (1) bolt
 (2) right engine guard
 (3) centre engine guard mounting bolts/collars
 (4) centre engine guard
 (10) tabs
 (11) grooves

10. Lubricate the drive chain (page 98).

11. Remove the battery and charge it fully. Store in an area protected from freezing temperatures and direct sunlight. Slow charge the battery (page 102) once a month.
12. Inflate the tyres to their recommended pressures (page 93).
13. Place your CRF on an optional workstand or equivalent to raise both tyres off the ground.
14. Stuff a rag into the muffler outlet. Then tie a plastic bag over the end of the muffler to prevent moisture from entering.
15. Store your CRF in an unheated area, free of dampness, away from sunlight, with a minimum of daily temperature variation.
16. Cover your CRF with a porous material. Avoid using plastic or similar nonbreathing, coated materials that restrict air flow and allow heat and moisture to accumulate.

Removal from Storage

- Uncover and clean your CRF. Change the engine and transmission oil if more than 4 months have passed since the start of storage (pages 44, 47).
 - Uncover the end of the muffler and remove the rag from the muffler outlet.
 - Fill the fuel tank with recommended fuel (page 41).
 - Charge the battery (page 102) as required. Install the battery.
 - Pour a fresh recommended coolant mixture (page 48) slowly into the radiator filler hole up to the filler neck.
 Capacity:
 1.45 ℓ (1.53 US qt, 1.28 Imp qt) at disassembly
 1.21 ℓ (1.28 US qt, 1.06 Imp qt) at draining
- Remove the radiator reserve tank cap and fill the reserve tank to the upper level line. Bleed air from the system (page 50).
- Perform all maintenance checks (page 11).