

5. Place an oil drain pan under the engine to catch the oil. Then remove the engine oil drain bolt (5) and O-ring (6).
6. After the oil has drained, apply engine oil to the drain bolt threads, seating surface and a new O-ring, then install the O-ring on the drain bolt and tighten the drain bolt to the specified torque:
13 lbf-ft (18 N·m, 1.8 kgf-m)

Pour the drained oil into a suitable container and dispose of it in an approved manner (page 160).

NOTICE

Improper disposal of drained fluids is harmful to the environment.

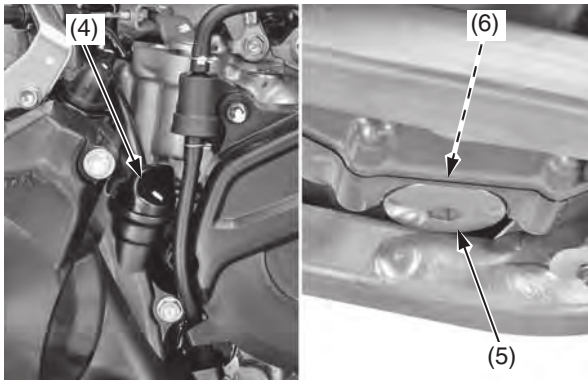

- (4) engine oil fill cap/dipstick
(5) engine oil drain bolt
(6) O-ring (new)

7. (Off-Road Use)
It is recommended to replace the oil and filter every 8 races or about every 30.0 hours. However, if you replace only the oil before the recommended interval, see page 36.
8. Remove the left crankcase over cover bolts (7) and over cover (8).

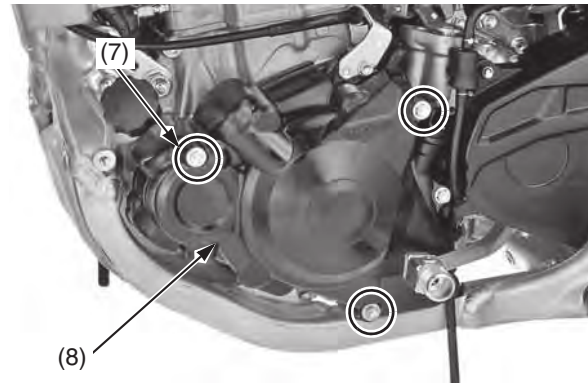

- (7) bolts (8) over cover

9. Remove the oil filter cover bolts (9) and oil filter cover (10).
10. Remove the oil filter (11), O-ring (12) and spring (13).

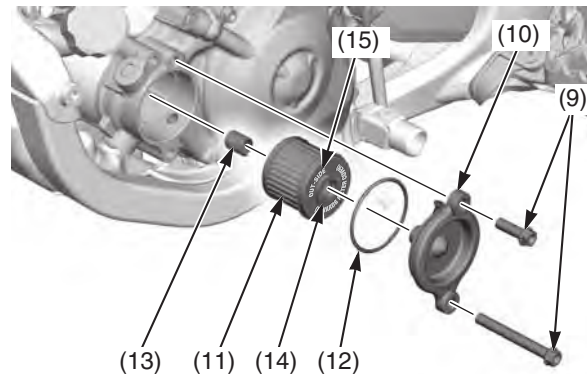

- (9) oil filter cover bolts (13) spring
(10) oil filter cover (14) rubber seal
(11) oil filter (15) "OUT-SIDE" mark
(12) O-ring

NOTICE

Using the wrong oil filter may result in leaks or engine damage.

11. Apply grease to the filter side of the spring end, then install the spring into a new oil filter.

12. Position the spring against the engine crankcase and install a new oil filter with the rubber seal (14) facing out, away from the engine. You should see the "OUT-SIDE" mark (15) on the filter body, near the seal. Use a new Honda Genuine oil filter or a filter of equal quality specified for your model.

NOTICE

If the oil filter is not installed properly, it will cause serious engine damage.

13. Apply engine oil to a new O-ring and install it to the oil filter cover.
14. Install the oil filter cover being careful not to damage the O-ring, then tighten the oil filter cover bolts to the specified torque:
7 lbf-ft (10 N·m, 1.0 kgf-m)
15. Install the left crankcase over cover, then tighten the over cover bolts to the specified torque:
7 lbf-ft (10 N·m, 1.0 kgf-m)
16. Install the engine guard, then tighten the engine guard A bolts/washers and B bolt/washer to the specified torque:
7 lbf-ft (10 N·m, 1.0 kgf-m)
17. Fill the crankcase with the recommended oil.
Capacity: 1.22 US qt (1.15 ℓ)
after draining and filter change
1.16 US qt (1.10 ℓ)
after draining

18. Install the engine oil fill cap/dipstick.
19. Check the engine oil level by following the steps in *Checking & Adding Oil* (page 70).

Pour the drained oil into a suitable container and dispose of it in an approved manner (page 160).

NOTICE

Improper disposal of drained fluids is harmful to the environment.