

## RIGHT HANDLEBAR

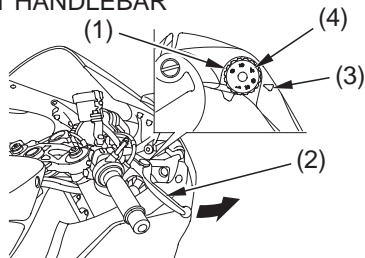

- (1) adjuster dial      (3) index mark  
(2) brake lever      (4) numbers

1. Turn the adjuster dial (1) while pushing the brake lever (2) forward.
2. Align the index mark (3) on the brake lever with the numbers (4) on the adjuster dial.
3. Apply the brake, release it, then spin the wheel and check that it rotates freely. Repeat this procedure several times.

### Brake Fluid Recommendation

brake fluid	Honda DOT 4 Brake Fluid
-------------	-------------------------

The recommended brake fluid is Honda DOT 4 Brake Fluid, or any brake fluid of equal quality and performance. Use fresh brake fluid from a sealed container. Be sure to read the label before opening the sealed container. An opened container may be contaminated or may have absorbed moisture from the air.