

(1) STEM  
(2) LOWER BEARING  
(3) DUST SEAL



(1) BALL RACE REMOVER

Remove the lower bearing and dust seal from the steering stem.

Remove the upper and lower bearing races from the steering head using the special tools.

**Tool:**  
**Ball race remover**      **07948-4630100**

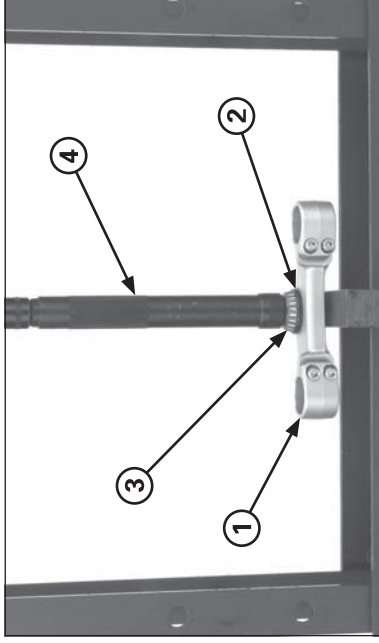

(1) STEM  
(2) DUST SEAL  
(3) BEARING  
(4) STEERING STEM DRIVER

Install new dust seal onto the steering stem.  
Install the new lower bearing into the steering stem using a hydraulic press and driver.

**Tool:**  
**Steering stem driver**      **07946-4300000**

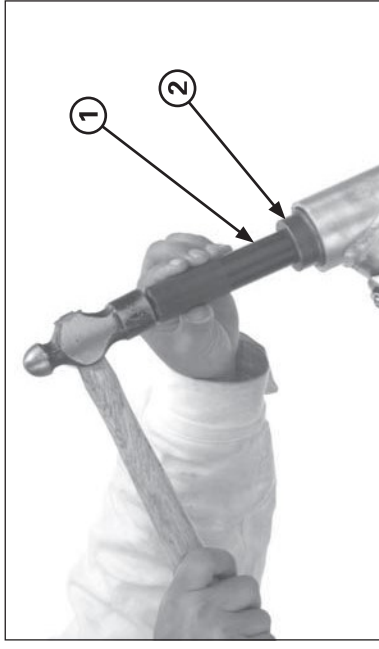

(1) DRIVER  
(2) ATTACHMENT



(1) STEM  
(2) UPPER BEARING  
(3) DUST SEAL

Install new bearing races.

**Tools:**  
**Driver**      **07749-0010000**  
**Attachment, 42 x 47 mm**      **07746-0010300**

Pack the upper and lower bearings with grease.  
Install the steering stem, upper bearing and dust seal.