

FUEL

Fuel Valve

The three way fuel valve (1) is on the left underneath the fuel tank.

“OFF”

At “OFF”, fuel cannot flow from the tank to the carburetors. Turn the valve off whenever the motorcycle is not in use.

“ON”

At “ON”, fuel will flow from the main fuel supply to the carburetors.

“RES”

At “RES”, fuel will flow from the reserve fuel supply to the carburetors. Use the reserve fuel only when the main supply is gone. Refill the tank as soon as possible after switching to “RES”. The reserve fuel supply is 2.0ℓ (0.5 US gal).

NOTE:

- * Do not operate the machine with the fuel valve in the “RES” position after refueling. You may run out of fuel, with no reserve.

WARNING

- * *Know how to operate the fuel valve while riding the motorcycle. You may avoid a sudden stop in traffic.*
- * *Be careful not to touch any hot engine parts while operating the fuel valve.*

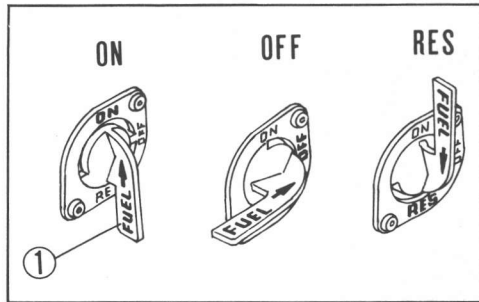

(1) Fuel valve