

# If a Fuse Blows

## Main Fuse Access

### UNDER SEAT

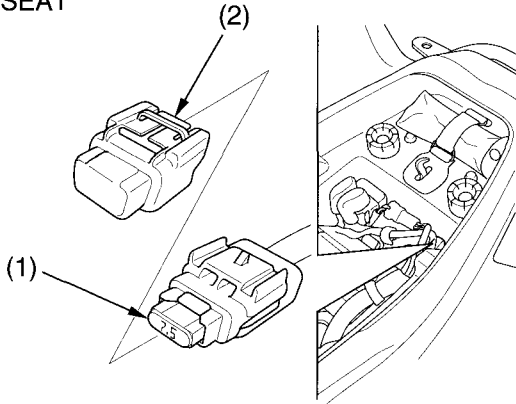

(1) fuse

(2) fuse case cover

1. To prevent an accidental short circuit, turn the ignition switch OFF (  $\bigcirc$  ) before checking or replacing the fuse.
2. To access the fuse ( 1 ), remove the seat ( page 95 ).
3. Remove the fuse case cover ( 2 ).
4. Replace the old fuse.
5. Reinstall the fuse case cover.
6. Install the seat.