

### Starting Procedure (After Preparation)

To restart a warm engine, follow the procedure for High Air Temperature.

#### Normal Air Temperature

10°–35 °C (50°–95 °F)

1. Pull the choke lever up all the way to fully ON (A).
2. Open the throttle slightly (1/8 – 1/4).  
(If the throttle limiter is adjusted as delivered, open the throttle fully.)

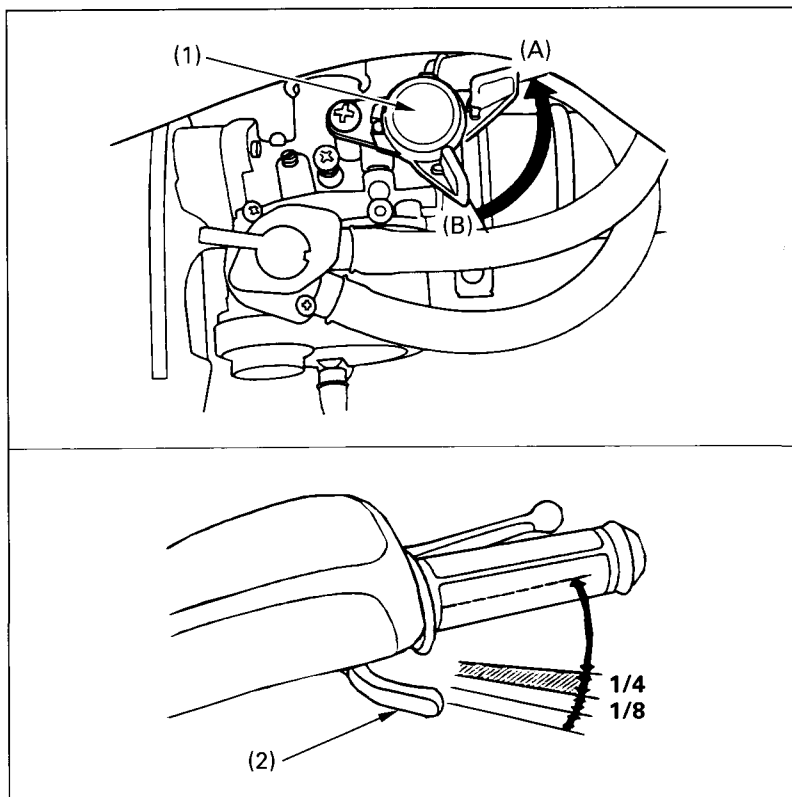

Fig. 3-11

(1) Choke lever  
(2) Throttle lever

(A) ON position  
(B) OFF position