

Spark Plug

Spark Plug Recommendation

standard spark plug	BKR5E-11 (NGK) or K16PR-U11 (DENSO)
---------------------	--

Use only the recommended type of spark plug in the recommended heat range.

NOTICE

Using spark plugs with an improper heat range can cause engine damage.

Spark Plug Replacement & Inspection

Refer to *Safety Precautions* on page 81.

1. Remove the seat (page 92).
2. Loosen the screw (1) and remove the clip (2).
3. Remove the resonance chamber (3).
4. Unhook the rubber cover (4).
5. Clean any dirt from around the spark plug base.
6. Disconnect the spark plug cap (5). Take care to avoid damaging the spark plug wire when disconnecting the cap.

UNDER SEAT

- (1) screw
- (2) clip
- (3) resonance chamber
- (4) rubber cover
- (5) spark plug cap

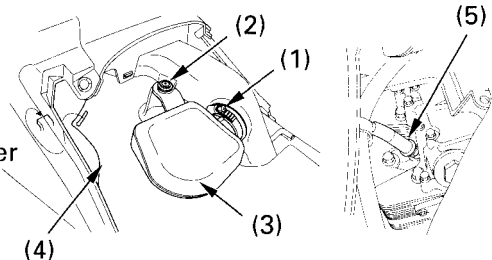

(cont'd)