

SEAT REMOVAL

To remove the seat (Fig. 4-34), pull up the seat lock lever (1) at the left side of the seat, then slide the seat backwards and lift it up.

To reinstall the seat, slide the front prong (3) into the recess (4) and press the seat down until it locks.

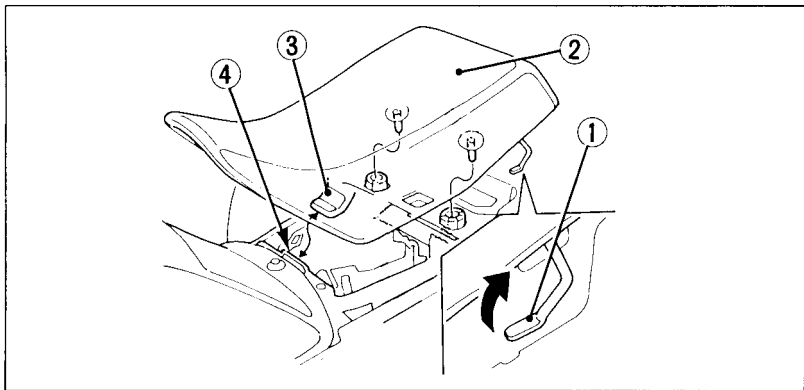

Fig. 4-34

(1) Seat lock lever

(2) Seat
(3) Front prong
(4) Recess