

Seat Removal

Refer to *Safety Precautions* on page 75 .

The seat must be removed for air cleaner, battery and fuse maintenance.

LEFT SIDE

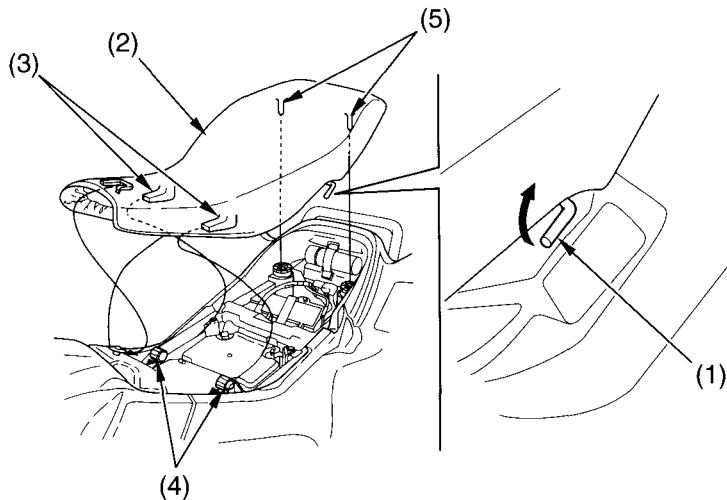

(1) seat lock lever

(2) seat

(3) front prongs

(4) hooks

(5) studs

Removal

1. Pull the seat lock lever (1) at the left side of the seat.
2. Slide the seat (2) back and lift it.

Installation

1. Insert the front prongs (3) into the hooks (4) on the frame and press the studs (5) into the grommets on the frame.
2. Press down on the seat until locks.