

LEFT CONSOLE BOX

There is a left console box (1) below the left side of the handlebar.

The maximum allowable load in the right console box and left console box shall be no more than

1.5 kg (3.3 lb).

Do not open the left console box while riding the scooter.

To Open:

Make sure the Honda smart card key is ON (page 63) and enter the operating range with card key.

Push the console box release button (2).

The left console box will come out slightly.

Push the left console box cover (3) gently so that you can pull it out fully.

If the left console box stops, pull it out with the notch (4).

When the left console box stops while pulling it out, push slightly and continue pulling.

To Close:

Press forward until it is firmly closed.

Do not put the card key, mechanical key and ID tag in the left console box.

The card key, mechanical key or ID tag may be locked inside and the card key system may not be activated.

Make sure the left console box is closed before riding.

When washing your scooter be careful not to flood this area with water.

Do not store valuables or fragile articles in the left console box.

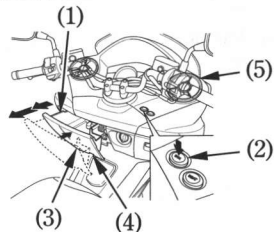

- | | |
|--|-------------------|
| (1) Left console box | (4) Notch |
| (2) Left console box
release button | (5) Speaker grill |
| (3) Left console box cover | |