

Exhaust Pipe/Muffler

Muffler Installation

1. Remove the old gasket.
2. Install the muffler clamp (1) by aligning the tab (2) of the muffler clamp with the cut-out (3) of each muffler (4).

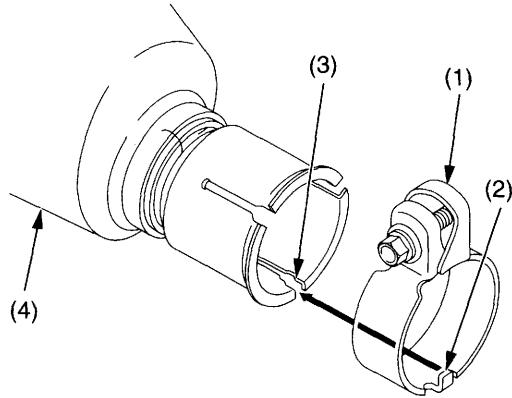

- (1) muffler clamp
(2) tab
(3) cut-out
(4) muffler

3. Install a new gaskets (5) to the exhaust joint pipe (6).
4. Install each muffler to the exhaust joint pipe.

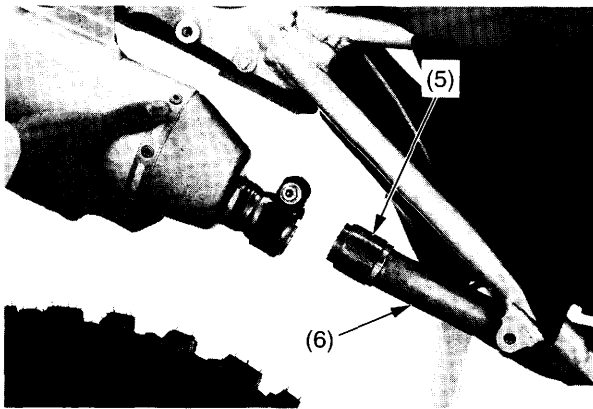

- (5) gasket
(6) exhaust joint pipe

5. Install each muffler mounting bolt (7) and washer (8).
6. Tighten each muffler clamp bolt (9) to the specified torque:
21 N·m (2.1 kgf·m, 15 lbf·ft)
7. Tighten each muffler mounting bolt to the specified torque:
26 N·m (2.7 kgf·m, 19 lbf·ft)

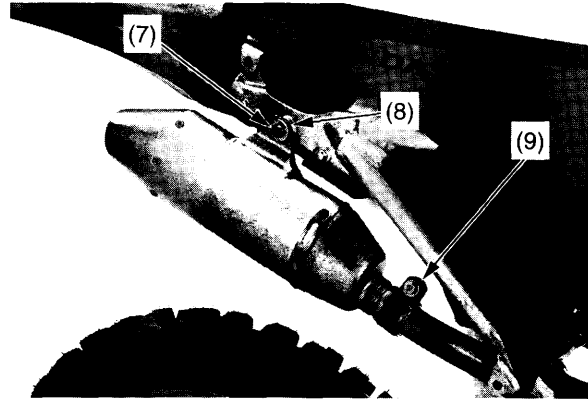

- (7) muffler mounting bolt
(8) washer
(9) muffler clamp bolt

8. Install and tighten the side covers (10) and side cover bolts (11).
9. Install the seat mounting bolts (12) and tighten them to the specified torque:
26 N·m (2.7 kgf·m, 19 lbf·ft)

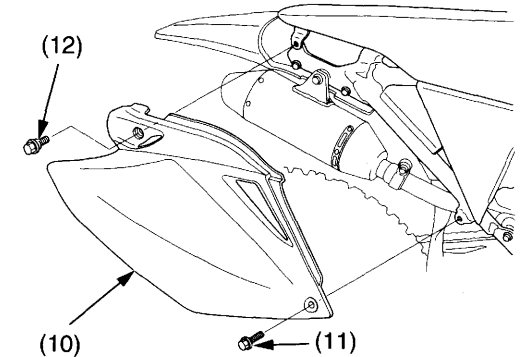

- (10) side cover
(11) side cover bolt
(12) seat mounting bolt